

# DURACELL®



TYPE LIST 2019/2020

# DURACELL STARTER

## QUALITY & RELIABILITY

**The gateway to the top quality world of the Duracell brand.** The Duracell Starter, which is equipped according to the latest standards, is the ideal first choice for customers seeking optimum performance at a super price. The Duracell Starter fulfils this wish to perfection, as it offers a combination of reliable power for every cold start, zero-maintenance due to modern full calcium technology, and maximum safety. The latter is ensured

by 4-chamber leak protection, which prevents vibration-related, battery acid escapes, together with a central venting system and a welded-in, captive flame arrester. Clear product coding with UK numbering and EN/SAE cold cranking values, as well as a range of 12 battery types from 44Ah to 95Ah, also demonstrate the universal suitability of this high value battery.

### Proven safety. 4-chamber leak protection

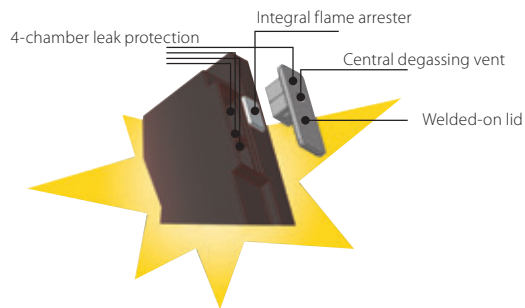

Battery type	Battery type UK	Part no.	Box	Capacity AH 20h	Cold crank current A EN	Cold crank current A SAE	Layout	Terminal	Length (max.) mm
									Length (max.) mm
<b>Duracell Starter (the starter battery for cars with fewer additional power consumers)</b>									
DS 44	UK 063	010 544 09 0801	LB1	44	360	400	0	1	210
DS 45	UK 048	010 545 77 0801	E2	45	300	320	0	1	218
DS 45L	UK 049	010 545 79 0801	E2	45	300	320	1	1	218
DS 45H	UK 012	010 545 59 0801	L1	45	400	420	0	1	210
DS 55	UK 065	010 555 19 0801	LB2	55	450	480	0	1	241
DS 60	UK 075	010 560 09 0801	LB2	60	480	500	0	1	241
DS 62	UK 027	010 562 19 0801	L2	62	510	540	0	1	241
DS 70	UK 100	010 570 44 0801	LB3	70	640	680	0	1	278
DS 72	UK 096	010 572 12 0801	L3	72	660	700	0	1	278
DS 72L	UK 086	010 572 33 0801	L3	72	660	700	1	1	278
DS 88	UK 017	010 588 20 0801	LB5	88	680	740	0	1	354
DS 95	UK 019	010 595 33 0801	L5	95	720	760	0	1	354



## DURACELL STARTER

Reliable starting power

Safety and leak protection due to a four-chamber flat lid with integrated arrester

Zero-maintenance owing to modern calcium technology

12 battery models from 44Ah to 95Ah

Product coding with UK number and EN/SAE cold crank power

Optimum price-performance ratio

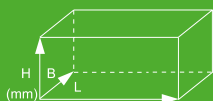

			Battery specifications	Base hold-down	Application
Width (max.) mm	Box height (max.) mm	Total height (max.) mm			
175	175	175	mGGA	B13	BMW, Opel, Renault, Fiat, Skoda, VW
135	203	225		B01	Renault R8-R13, Dacia
135	203	225		B01	Peugeot, Honda, Dacia
175	190	190	mGGA	B13	Audi, BMW, VW, Citroen, Peugeot, Renault, Fiat, Skoda
175	175	175	mGGA	B13	BMW, Fiat, Ford, Peugeot, Renault
175	175	175	mGGA	B13	Mercedes, BMW, Opel, Peugeot, Renault, Ford
175	190	190	mGGA	B13	Mercedes, BMW, VW, Opel, Peugeot, Citroen
175	175	175	mGGA	B13	Mercedes, BMW, Opel, Fiat, Ford
175	190	190	mGGA	B13	Mercedes, BMW, VW, Opel, Fiat, Peugeot, Citroen
175	190	190	mGGA	B01	Chrysler Voyager
175	175	175	mGGA	B13	BMW D, Citroen D, Mercedes D, VW D
175	190	190	mGGA	B13	Audi, BMW, Mercedes, Porsche, VW

# DURACELL ADVANCED

## MORE POWER & LONGER LIFE

**Maximum power for starting and vehicle systems.** The Duracell Advanced is the embodiment of Duracell Automotive brand quality! This power pack meets the highest demands of leading vehicle manufacturers and is therefore the ideal battery for the modern car. Its design combines full calcium technology for increased starting power with the greatest possible safety. This is provided by a double lid, which prevents acid leaks even if the

battery is tipped up or rolled over, and combines improved safeguards against gas ignition and electrostatic discharge with dual option gas venting. The Duracell Advanced is ideal for modern SUVs and offers optimised cold cranking values, robust cyclic behaviour and zero-maintenance. 28 battery types also ensure suitability for virtually all European and Asian makes.



Battery type	Battery type UK	Part no.	Box	Capacity AH 20h	Cold crank current A EN	Cold crank current A SAE	Layout	Terminal	Length (max.) mm
<b>Duracell Advanced (= High performance SLI-battery for modern cars with many on-board electronics)</b>									
DA 40B	UK 054 BH	013 540 25 0801	35NS / B19	40	330	360	0	3	187
DA 40	UK 054	013 540 26 0801	35NS / B19	40	330	360	0	3	187
DA 40L	UK 055	013 540 27 0801	35NS / B19	40	330	360	1	3	187
DA 42	UK 202	013 542 08 0801	L0	42	390	420	0	1	175
DA 44	UK 063	013 544 09 0801	LB1	44	420	450	0	1	210
DA 45	UK 044	013 545 23 0801	45NS / B24	45	390	420	0	1+3	238
DA 45L	UK 043	013 545 24 0801	45NS / B24	45	390	420	1	1+3	238
DA 50	UK 012	013 550 03 0801	L1	50	450	480	0	1	210
DA 50T <b>NEW</b>	UK 063	013 550 42 0801	LB1	50	400	420	0	1	210
DA 50H <b>NEW</b>	UK 012	013 550 40 0801	L1	50	420	450	0	1	210
DA 60	UK 005L	013 560 68 0801	D23	60	510	550	0	1	233
DA 60L	UK 005R	013 560 69 0801	D23	60	510	550	1	1	233
DA 60T	UK 075	013 560 09 0801	LB2	60	540	600	0	1	241
DA 62H	UK 027	013 562 19 0801	L2	62	550	600	0	1	241
DA 63T <b>NEW</b>	UK 075	013 563 42 0801	LB2	63	600	650	0	1	241
DA 63H	UK 027	013 563 40 0801	L2	63	620	665	0	1	241
DA 70	UK 068	013 570 29 0801	D26	70	600	650	0	1	260
DA 70L	UK 069	013 570 24 0801	D26	70	600	650	1	1	260
DA 72	UK 100	013 572 09 0801	LB3	72	670	710	0	1	278
DA 74	UK 096	013 574 12 0801	L3	74	680	740	0	1	278
DA 77T <b>NEW</b>	UK 100	013 577 42 0801	LB3	77	680	740	0	1	278
DA 77H <b>NEW</b>	UK 096	013 577 40 0801	L3	77	700	750	0	1	278
DA 80	UK 110	013 580 14 0801	LB4	80	700	750	0	1	315
DA 95	UK 249	013 595 04 0801	D31	95	740	780	0	1	303
DA 95L	UK 250	013 595 05 0801	D31	95	740	780	1	1	303
DA 95H	UK 019	013 595 33 0801	L5	95	780	820	0	1	354
DA 100	UK 019	013 600 40 0801	L5	100	820	860	0	1	354
DA 110	UK 020	013 610 40 0801	L6	110	900	950	0	1	394





## DURACELL ADVANCED

Improved cold crank characteristics, maximum starting power

Zero maintenance owing to modern calcium technology

Offers high on-board power due to robust cyclic behaviour

Maximum leak and gas ignition protection, superior ESD-safety

Vibration resistant due to the bonding of the plates to the battery floor

28 battery types from 40Ah to 110Ah

Product coding with UK number and EN/SAE cold crank power

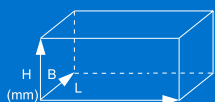

			Battery specifications	Base hold-down	Application
Width (max.) mm	Box height (max.) mm	Total height (max.) mm			
137	204	226	mGGA	B01	Hyundai Atos, i 10, Kia Picanto, Honda Jazz 03-
127	204	226	mGGA	B00	Daihatsu, Honda, Mitsubishi, Subaru, Suzuki
127	204	226	mGGA	B00	Suzuki, Daihatsu, Honda, Subaru
175	190	190	GA	B13	Fiat, Alfa Romeo, Lancia, Aixam 99-
175	175	175	mGGA	B13	BMW, Ford, Opel, Renault, Fiat, Skoda, VW
129	203	225	mGGA	B00	Toyota, Subaru, Mazda, Suzuki, Toyota
129	203	225	mGGA	B00	Daihatsu, Mitsubishi, Honda, Suzuki, Hyundai
175	190	190	mGGA	B13	Fiat, Alfa Romeo, Lancia, Citroen, Peugeot
175	175	175	mGGA	B13	Ford, Opel
175	190	190	mGGA	B13	Fiat, Alfa Romeo, Lancia, Citroen, Peugeot
173	203	225	mGGA	B00	Mazda, Subaru, Nissan, Suzuki, Toyota, Hyundai, Kia
173	203	225	mGGA	B00	Nissan, Toyota, Honda, Mazda, Isuzu, Mitsubishi
175	175	175	mGGA	B13	Ford, Opel
175	190	190	mGGA	B13	Mercedes, BMW, Opel, Peugeot, Renault
175	175	175	mGGA	B13	Ford, Opel
175	190	190	mGGA	B13	Mercedes, BMW, VW, Opel, Peugeot, Citroen
174	200	222	mGGA	B01	Daihatsu, Honda, Isuzu, Mazda, Mitsubishi, Nissan
174	200	222	mGGA	B01	Volvo, Honda, Hyundai, Isuzu, Kia, Mitsubishi, Nissan
175	175	175	mGGA	B13	Ford, Opel
175	190	190	mGGA	B13	Mercedes, BMW, VW, Opel, Fiat, Peugeot, Citroen
175	175	175	mGGA	B13	Ford, Opel
175	190	190	mGGA	B13	Mercedes, BMW, VW, Opel, Fiat, Peugeot, Citroen
175	175	175	mGGA	B13	Audi D, BMW D, Nissan D, Renault D, VW D
173	203	225	mGGA	B07	Fiat Tractors, Mazda D, Nissan, Toyota D, Hyundai D, Kia D
173	203	225	mGGA	B07	Nissan D, Toyota D, Mitsubishi D, Hyundai D, Kia D
175	190	190	mGGA	B13	Audi, BMW, Mercedes, Porsche, VW
175	190	190	mGGA	B13	Audi, BMW, Mercedes, Porsche, VW
175	190	190	mGGA	B13	Audi, BMW, Mercedes, Porsche, VW

\* ESD = electrostatic discharges are disruptive voltage breakdowns caused by major potential differences. These discharges (sometimes visible due to sparks) create brief, electrical current surges and can lead to the ignition of flammable material. It is precisely this danger that the ESD plugs prevent with absolute safety.

# DURACELL EXTREME

## THE START/STOP SPECIALISTS

**EFB and AGM Technology for stop-start vehicles.** The Duracell Extreme is designed for use in environment-friendly vehicles fitted with a stop-start function. The enhanced flooded battery (EFB) is employed primarily in medium-sized and small cars, and for stop-start systems requiring a high energy input.

The absorbent glass mat (AGM) battery is installed mainly in medium-sized and luxury class vehicles requiring maximum power and fitted with stop-start systems and brake energy recuperation. Duracell Extreme premium products meet the demands of leading car manufacturers and with a range of seven types from 60Ah to 105Ah, are the first choice for fuel-efficient cars.

**Duracell Extreme –  
the modern power pack  
for stop-start vehicles**



**3x durability &  
cycle-resistance**



**2x durability &  
cycle-resistance**



Battery type	Battery type UK	Part no.	Box	Capacity AH 20h	Cold crank current A EN	Cold crank current A SAE	Layout	Terminal	Length (max.) mm
<b>Duracell Extreme AGM (for vehicles with stop/start systems, a maximum energy requirement and braking energy recuperation)</b>									
DE 70 AGM	UK 096 AGM	016 570 01 0801	L3	70	720	760	0	1	278
DE 80 AGM	UK 110 AGM	016 580 01 0801	L4	80	800	850	0	1	315
DE 92 AGM	UK 019 AGM	016 592 01 0801	L5	92	850	900	0	1	354
DE 105 AGM <b>NEW</b>	UK 020 AGM	016 605 01 0801	L6	105	950	1000	0	1	394
<b>Duracell Extreme EFB (for vehicles with stop/start-systems and a high energy requirement)</b>									
DE 60 EFB	UK 027 EFB	012 560 11 0801	L2	60	560	600	0	1	241
DE 70 EFB	UK 096 EFB	012 570 11 0801	L3	70	660	700	0	1	278
DE 80 EFB <b>NEW</b>	UK 115 EFB	012 580 11 0801	L4	80	780	820	0	1	315



### DURACELL EXTREME EFB

Cycle-resistant starter battery – 3 types with 60/70/80Ah

Twice the cycle resistance of standard batteries

Nonwoven cover on the separator and special active mass composition

Double lid for maximum leak protection and operational safety

Top V3 vibration resistance rating pursuant to EN 50342-1:2016

Zero maintenance owing to modern calcium technology

Product coding with UK number and EN/SAE cold crank power

### DURACELL EXTREME AGM

Valve-regulated, nonwoven glass mat battery (VRLA) –

4 types with 70/80/92/105Ah

Three times the cycle resistance of standard batteries

Leak-proof due to electrolyte bonding into a glass nonwoven (absorbent glass mat)

Zero maintenance owing to recombination technology

Very low internal resistance – maximum starting power

Installation in a lateral position possible (max. 90° angle)

Product coding with UK number and EN/SAE cold crank power

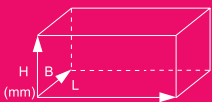

			Battery specifications	Base hold-down	Application
Width (max.) mm	Box height (max.) mm	Total height (max.) mm			
175	190	190	mG	B13	BMW, VW, Audi, Mercedes, Porsche, Taxis
175	190	190	mG	B13	BMW, VW, Audi, Mercedes, Porsche, Taxis
175	190	190	mG	B13	BMW, VW, Audi, Mercedes, Porsche, Taxis
175	190	190	mG	B13	BMW, VW, Audi, Mercedes, Porsche, Taxis
175	190	190	mGGA	B13	Alfa Romeo, Audi, BMW, Citroen, Fiat, Peugeot, Seat, Skoda, Toyota, VW
175	190	190	mGGA	B13	Alfa Romeo, Audi, BMW, Citroen, Fiat, Peugeot, Seat, Skoda, Toyota, VW
175	190	190	mGGA	B13	Alfa Romeo, Audi, BMW, Citroen, Fiat, Peugeot, Seat, Skoda, Toyota, VW

# DURACELL PROFESSIONAL

## THE POWER IN LONG-DISTANCE TRUCKS

The batteries employed for the electrical systems in commercial vehicles have to provide top performance on a daily basis and in addition, the steady increase in the number of comfort functions demands large quantities of energy. In particular, this applies when long-distance truck drivers remain in their vehicles overnight and use a very large number of power consumers. Moreover, if the battery is to be integrated into the rear section of the truck frame, it must be extremely robust and vibration-resistant.

**DURACELL's powerful response to these special demands comes in the shape of the new PROFESSIONAL EFB, which is all the more**

essential owing to the fact that the long-distance truck of today is no longer merely a means of transportation. In fact, it is both a workplace and frequently a home for up to five days at a stretch. Therefore, it is good to know that a strong electrical system battery can be relied upon to supply lighting, air conditioning, the kitchen unit, entertainment and many other comforts.

Please note when exchanging the battery that a vehicle fitted with an EFB battery may never be retrofitted with a conventional wet battery. Should battery replacement become necessary, always use an EFB battery with an identical box and performance class.



Battery type	Battery type UK	Part no.	Box	Capacity AH 20h	Cold crank current A EN	Cold crank current A SAE	Layout	Terminal	Length (max.) mm
<b>Duracell PROfessional EFB (batteries for long-distance trucks with a maximum energy requirement)</b>									
DP 190 EFB <b>NEW</b>	UK 629 EFB OE	012 690 17 0801	B	190	1050	1100	3	1	514
DP 240 EFB <b>NEW</b>	UK 632 EFB OE	012 740 17 0801	C	240	1200	1250	3	1	517
<b>Duracell PROfessional (heavy duty &amp; super heavy duty batteries for trucks, buses, agricultural &amp; construction machinery &amp; snow groomers)</b>									
DP 110 SHD	UK 615 SHD	018 610 40 0801	MAC 110	110	760	800	3	1	514
DP 110	UK 663	010 61047 0801	Compact	110	800	850	0	1	344
DP 110L	UK 664	010 61048 0801	Compact	110	800	850	1	1	344
DP 135 SHD	UK 630 SHD	018 635 44 0801	MAC 110	135	900	950	3	1	514
DP 140	UK 637	010 640 35 0801	A	140	760	800	3	1	514
DP 145 SHD	UK 637 SHD	018 645 03 0801	A	145	800	850	3	1	514
DP 170 SHD	UK MAC 140 SHD	018 670 33 0801	MAC 140 SHD	170	1000	1050	3	1	514
DP 180	UK 629	010 680 32 0801	B	180	950	1000	3	1	514
DP 180 SHD	UK 629 SHD	018 680 08 0801	B	180	1000	1050	3	1	514
DP 225	UK 632	010 725 11 0801	C	225	1050	1100	3	1	517
DP 225 SHD	UK 632 SHD	018 725 03 0801	C	225	1150	1200	3	1	517





## PROFESSIONAL HD

Simple maintenance: externally visible electrolyte level markings, practical plugs

Robust design with set bonding

Envelope separator to protect against short circuits

Product coding with UK number and EN/SAE cold cranking power

Optimum price-performance ratio

## PROFESSIONAL SHD

Super Heavy Duty for extra cyclic and vibration resistance

Calcium technology ensures minimum water consumption

6 types from 110 to 225Ah

Superior safety: central degassing, external ignition protection, safety plugs

Improved leak protection for models 145/180/225Ah due to 4-chamber flat lid with a welded-in, captive arrester

Product coding with UK number and EN/SAE cold crank power



## PROFESSIONAL EFB

Increased cyclic resistance owing to an active mass recipe and non-woven, electrode sleeves

Robust design and optimum vibration resistance due to special set anchorage

Calcium technology for minimum water consumption

Maintenance-free (no topping-up with water) under normal operating conditions

Central degassing with integrated external ignition protection

Add-ons such as short circuit protection and ESD plugs\* for enhanced product safety

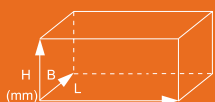

			Battery specifications	Base hold-down	Application
Width (max.) mm	Box height (max.) mm	Total height (max.) mm			
223	195	220	mGGARZS	B00	Fern-LKW: MAN, Mercedes, Volvo, Scania, Steyr Trucks
273	212	240	mGGARZS	B00	Fern-LKW: MAN, Mercedes, Volvo, Scania, Steyr Trucks
175	210	210	mGGARZS	B03	MAN, Mercedes, Roman, Robur
172	214	230	mG	B00	IHC, Massey Ferguson
172	214	230	mG	B00	IHC, McCormick
175	210	210	mGGARZS	B03	MAN, Mercedes, Roman
189	195	220	mG	B00/01	Steyr Trucks, MAN, Mercedes
189	195	220	mGGARZS	B00	Neoplan, MAN, Mercedes, Volvo, Scania, Steyr Trucks
218	210	210	mGGARZS	B03	MAN, Mercedes, Liaz
223	195	220	mG	B00	Steyr Trucks, MAN, Roman, Multicar
223	195	220	mGGARZS	B00	Neoplan, MAN, Mercedes, Volvo, Scania, Steyr Trucks
273	212	240	mG	B00	Steyr, MAN, Volvo Trucks
273	212	240	mGGARZS	B00	Neoplan, MAN, Mercedes, Volvo, Scania, Steyr Trucks

\* ESD = electrostatic discharges are disruptive voltage breakdowns caused by major potential differences. These discharges (sometimes visible due to sparks) create brief, electrical current surges and can lead to the ignition of flammable material. It is precisely this danger that the ESD plugs prevent with absolute safety.

# DURACELL LEISURE

## DURABILITY & CYCLIC RESISTANCE

**Leisure batteries must provide guaranteed top performance over long periods and be insensitive to deep discharging and frequent recharging.**

With the “Leisure” product line Duracell offers a complete range of deep discharge resistant, wet batteries with superior power reserves, outstanding safety features and reduced water consumption, which are ideally combined in a robust and vibration-resistant design.

Therefore, Duracell Leisure batteries are ideal for every type of leisure and in particular camping, caravanning, mobile homes, boats and marine applications.

This is because these tough, leisure specialists can easily handle the toughest demands such as vibrations, heavy swell, extremely long-term loads such as those incurred during trolling, and severe tilting. They deliver on-board power reliably and whenever it is needed.



Battery type	Battery type UK	Part no.	Box	Capacity AH 20/5/100h	Layout	Terminal	Length (max.) mm
<b>Duracell Leisure (robust, long discharge battery for hobbies and leisure)</b>							
DL72L	678 Box Premium Leisure	010 955 51 0801	D26 / MO60	72/55/85	1	1	256
DL100	110LB / 019 Box Premium Leisure	010 957 51 0801	L5	100/75/110	0	1	354
DL115	110 / 679 Box Premium Leisure	010 959 01 0801	LOT7	115/90/135	0	1	350





## DURACELL LEISURE

Durability and cyclic resistance

Maximum on-board power

Superior safety features

Robust, vibration-resistant design

Maintenance-friendly due to low water consumption

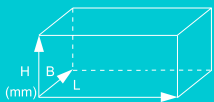

			Battery specifications	Base hold-down	Application
Width (max.) mm	Box height (max.) mm	Total height (max.) mm			
174	205	225	mGGA	B00	Boats/marine, camping/caravanning, wheelchairs
175	190	190	mGGA	B13	Boats/marine, camping/caravanning, wheelchairs
175	230	230	mGGA	B01	Boats/marine, camping/caravanning, wheelchairs

## SWITCHING

	6 Volt	12 Volt
0		
1		
2		
3		
4		
5		
6		
9		
10		

## TERMINALS

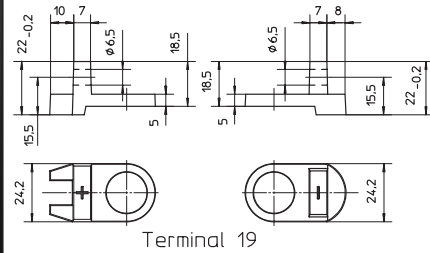
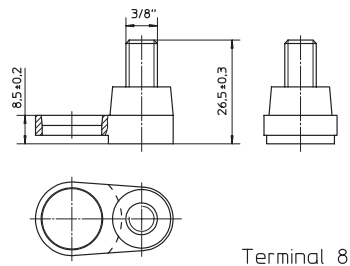
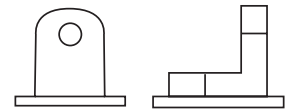
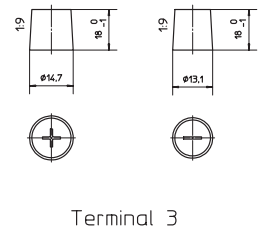
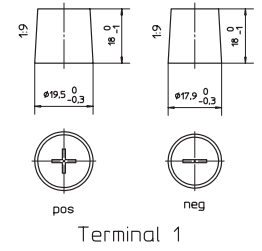



BASE HOLD-DOWNS

<p>Terminal 4</p>
<p>Terminal 5</p>
<p>Dimension as shown in fig. 'terminal 1'</p> <p>Terminal 20</p>
<p>Terminal K</p> <p>Terminal 21</p>

B 00	without hold down		
B 01	3 notches		
B 03	3 notches	3 notches	
B 04	3 notches		
B 05	3 notches		
B 06			
B 07			
B 09			
B 11		3 notches	
B 12		3 notches	
B 13	5 notches	3 notches	
B 14	5 notches		

mg = with handles  
 GA = battery with central degassing  
 RZS = external ignition protection

# DURACELL TRUST IS

Stationary heating	800 W
HIFI system, 4-channel amplifier	200 W
Radio with CD player	60 W
Air conditioning	100 W
Engine control/ignition	20 W
Fuel injection	100 W
Windscreen heating	1,000 W
Passenger compartment fan	150 W
Front windscreen wipers	80 W
Radiator fan	500 W
Headlights	130 W
Headlight washing system	50 W
Fog lamps	100 W
ESP / ABS	100 W
Steering wheel heating	50 W
Mobile navigation device	10 W

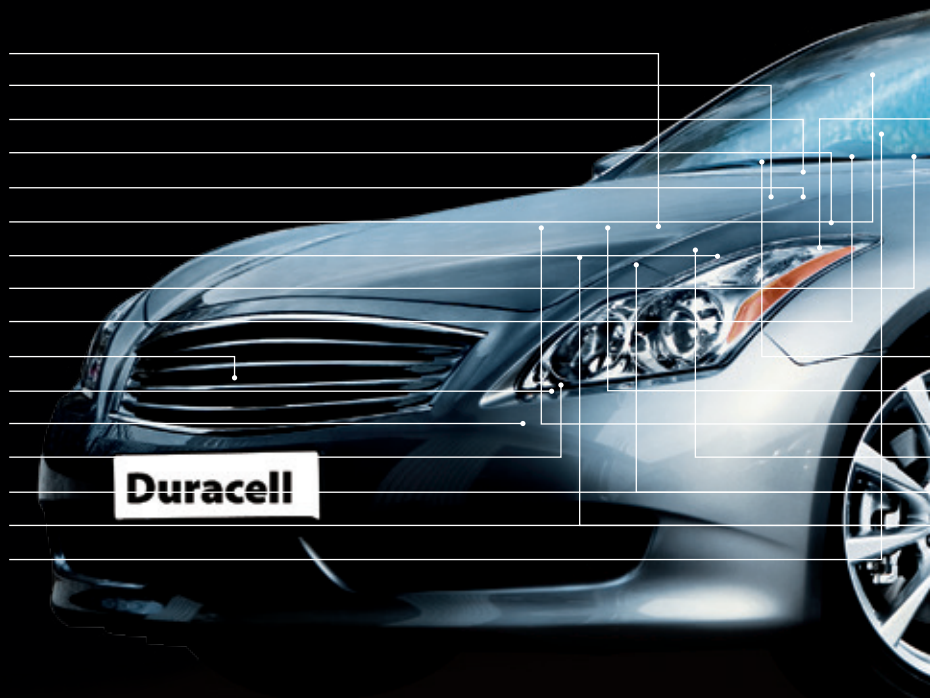

**IT'S HARD TO BELIEVE  
WHAT YOUR DURACELL  
BATTERY CAN DO!**

# DURACELL<sup>®</sup> S POWER.

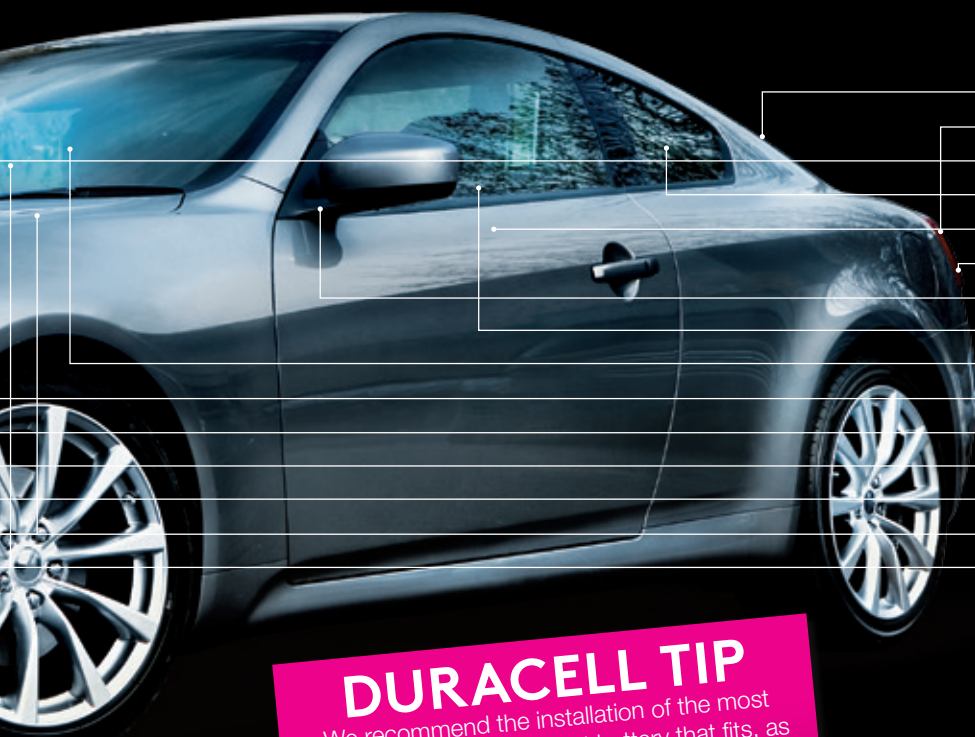

50 W	Rear window wiper
40 W	Rear lights
40 W	Indicator lights
200 W	Rear window heating
60 W	Seat heating
40 W	Rear fog lights
30 W	Heated rear-view mirrors
100 W	Electric windows
2 W	I-pod
40 W	Heated washer nozzles
60 W	Fuel pump
180 W	Engine management
120 W	Steering booster pump
200 W	Oil pump
250 W	Water pump

## DURACELL TIP

We recommend the installation of the most powerful and hence largest battery that fits, as this provides additional performance reserves.

All the above values are averages.

The Duracell battery constitutes the heart of your car. It has been uncompromisingly designed for power, in order to provide top performance at any time. In modern cars, the energy demand of electronic consumers exceeds the capacity of the dynamo and therefore the battery is subject to additional burdens. Indeed, an electrical energy requirement of 5,000 V is not unusual.

**Power savings also conserve fuel.** The use of 100 W of electricity means fuel consumption of 0.1 l/100 km. Therefore it's best to switch off consumers when they are not needed!

# DURACELL®

**Duracell Automotive c/o Banner GmbH**

Bannerstrasse 1, A-4021 Linz

Tel. +43/(0)732/38 88-0, Fax DW-21599

E-mail: [info@duracell-automotive.com](mailto:info@duracell-automotive.com)

[www.duracell-automotive.com](http://www.duracell-automotive.com)