



LP12-45 (12V 45.0 Ah)

Specifications

Rated Voltage	12
Nominal Capacity	45.0 Ah (C ₂₀ , 1.80V/cell)
Dimensions	Length 197 mm
	Width 165 mm
	Container Height 170 mm
	Total Height 170 mm
Approx. Weight	14.5 Kg (32.0 lbs)
Terminal	T6
Layout	3
Container material	ABS
Rated Capacity (25°C)	45.0 Ah (20hr, 2.25A, 1.80V/cell)
	42.8 Ah (10hr, 4.281A, 1.80V/cell)
	36.8 Ah (5hr, 7.36A, 1.75V/cell)
	33.3 Ah (3hr, 11.1A, 1.75V/cell)
	26.1 Ah (1hr, 26.1A, 1.60V/cell)
Max. Discharge Current	540A (5s)
Internal Resistance (25°C)	Approx 9mΩ
Operating Temp. Range	Discharge: -15°C ~50°C (5~122°F)
	Charge: 0°C ~40°C (32~104°F)
	Storage: -15°C ~40°C (5~104°F)
Nominal Operating Temp. Range	25±3°C (77±5°F)
Cycle Use	Initial Charging Current less than 13.5A. Voltage 14.4V~15.0V at 25°C (77 °F)Temp. Coefficient -20mV/°C
Standby Use	No limit on Initial Charging Current Voltage
	13.5V~13.8V at 25°C (77 °F)Temp. Coefficient -20mV/°C
Effect Of Temp. To Capacity	40°C (104°F) 103%
	25°C (77°F) 100%
	0°C (32°F) 86%
Self Discharge	LP series batteries may be stored for up to 6 months at 25°C (77°F) and then a freshening charge is required. For higher temperatures the time interval will be shorter.



G123017



Description and Features

The LP Series AGM batteries have been specially developed to be widely applicable. These lead acid batteries with AGM technology are completely sealed and therefore 100% maintenance free and leak-proof. These batteries have a low self-discharge. The reliable and safe multipurpose batteries from the LP Series offer a long service life and can be used in various industries.

Features

- Absorbent Glass Mat technology
- Reliable and safe performance
- Long service life - 3-5 years in standby application (at 25°C)
- Suitable for multipurpose applications

Layout

Terminal

UL certification

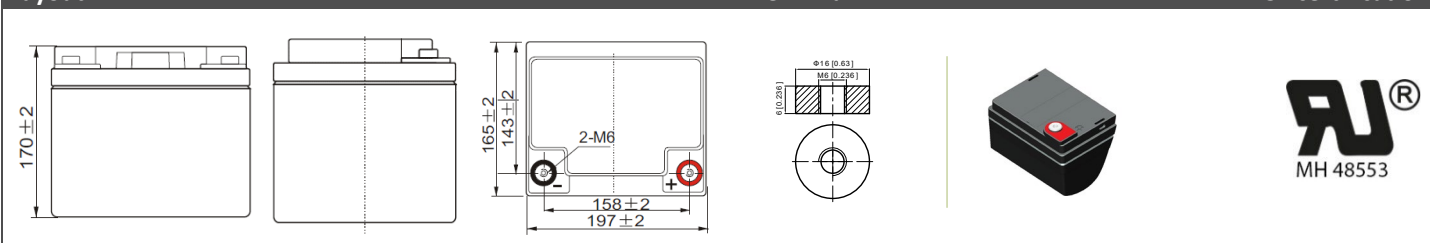

Constant Current Discharge Characteristics: A (25°C)

F.V/Time	5 Min	10 Min	15 Min	20 Min	30 Min	45 Min	1 Hr	2 Hr	3 Hr	4 Hr	5 Hr	6 Hr	8 Hr	10 Hr	20 Hr
1.85V/cell	73.2	57.6	49.0	40.9	32.5	24.6	20.2	12.8	10.2	8.30	6.69	5.82	4.73	4.04	2.23
1.80V/cell	98.3	73.6	59.1	48.4	38.4	28.6	22.6	14.0	10.9	8.86	7.18	6.25	5.01	4.28	2.25
1.75V/cell	110.8	80.8	64.6	52.1	39.9	29.7	23.6	14.5	11.1	9.06	7.36	6.42	5.10	4.32	2.27
1.70V/cell	122.0	88.1	69.0	54.7	41.5	30.9	24.4	15.1	11.4	9.30	7.55	6.55	5.17	4.36	2.32
1.67V/cell	134.6	95.1	73.3	58.1	43.8	31.7	25.2	15.5	11.9	9.62	7.76	6.70	5.25	4.45	2.35
1.60V/cell	148.4	103.2	78.4	61.9	46.2	33.0	26.1	16.1	12.3	9.92	8.02	6.84	5.30	4.50	2.36

Constant Power Discharge Characteristics: Wpc (25°C)

F.V/Time	5 Min	10 Min	15 Min	20 Min	30 Min	45 Min	1 Hr	2 Hr	3 Hr	4 Hr	5 Hr	6 Hr	8 Hr	10 Hr	20 Hr
1.85V/cell	133.9	106.3	91.3	77.2	62.0	47.3	38.9	24.9	19.8	16.2	13.1	11.4	9.33	8.00	4.42
1.80V/cell	177.8	134.3	108.9	89.9	72.1	54.6	43.3	27.0	21.2	17.2	14.0	12.2	9.87	8.46	4.46
1.75V/cell	196.2	145.2	117.5	95.8	74.2	56.2	45.1	27.9	21.5	17.6	14.3	12.5	10.0	8.53	4.49
1.70V/cell	210.0	154.6	123.7	99.9	76.8	58.2	46.4	29.0	22.1	18.0	14.7	12.8	10.1	8.61	4.57
1.67V/cell	228.3	165.4	130.5	105.3	80.4	59.1	47.6	29.6	22.9	18.5	15.0	13.0	10.3	8.77	4.63
1.60V/cell	246.0	175.4	137.2	111.0	84.2	61.3	49.1	30.5	23.5	19.0	15.5	13.3	10.4	8.85	4.65



LP12-45 (12V 45.0 Ah)

Discharge Characteristics

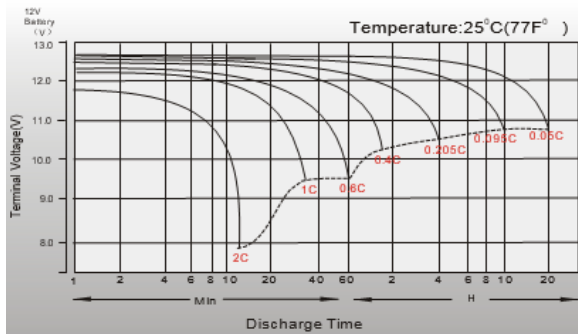

Float Charging Characteristics

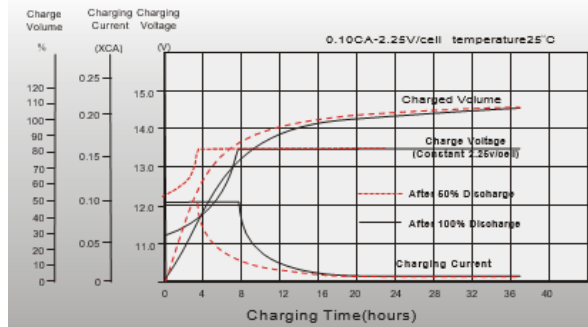

Temperature Effects In Relation To Battery Capacity

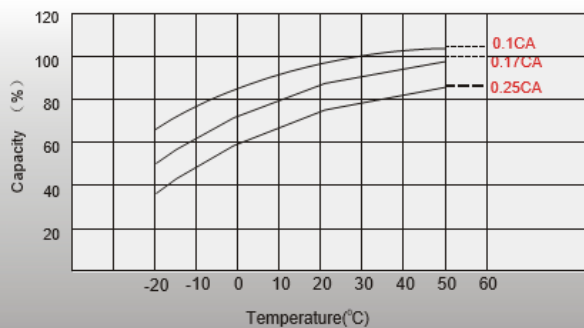

Float Service Life

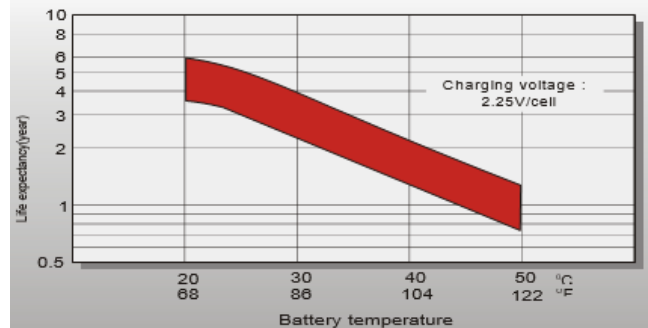

Applications

- All purpose
- Uninterruptable Power Supply (UPS)
- Electric Power System (EPS)
- Emergency backup power supply
- Alarm and security system
- Communication power supply
- DC power supply
- Auto control system

General Features

- 5 years design life(25°C)
- Special exhaust structure and sealing technology, safe and reliable, flexible installation, convenient maintenance
- PbCaSn alloy for plate grids: less gassing, less self-discharging
- High quality AGM separator: extend cycle life and prevent micro short circuit
- High purity raw material: ensure low self discharge rate

Standards

- Compliance with IEC 60896 standards, EU Battery Directive
- UL, CE Certified
- UKCA Certified (for UK)
- IATF16949, ISO45001,ISO 9001 and ISO 14001 certified production facilities

(Note) All above information shall be changed without prior notice, Landport Batteries reserves the right to explain and update the latest information.