

LT12B-BS (12V 10Ah)



Item Code: MA LT12B-BS
EAN: 8717101021132

Features

- ⚡ Absorbent Glass Mat technology
- ⚡ Advanced starting power
- ⚡ Can be installed in tilted positions up to 45°
- ⚡ 100% maintenance free, once activated
- ⚡ Supplied with acid pack



Specifications

Nominal Voltage	12V
Cold Cranking Ampere (CCA)	175A
Nominal Capacity	10 Ah
Container Material	ABS
Approx. Weight	3.36 kg (7.41lbs)
Acid Weight	0.69 kg (1.52lbs)
Layout	1
Terminal	F
Dimensions	
	Length 150 mm
	Width 70 mm
	Height 130 mm
	Total Height 130 mm

Size



Position of Terminals

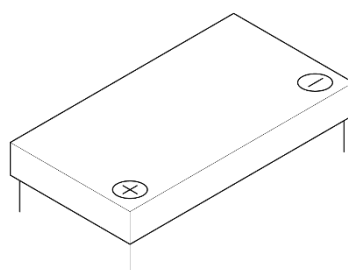

Terminal

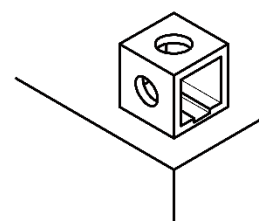

Alternatives

LP Batteries

Technology	Art. number
LFP	ML LFP14
GEL	MG LT12B-4
SLA	MS LT12B-4
DRY	

Other Brands

IS CT12B-4 – IG CT12B-4 – IL LFP14

(Note) All above information shall be changed without prior notice, Landport Batteries reserves the right to explain and update the latest information.