

LB9L-A2 (12V 9Ah)



Item Code: MD L94L-A2
EAN: 8717101017074

Features

- ⚡ Conventional battery
- ⚡ Robust technology
- ⚡ Reliable starting battery
- ⚡ OEM Quality
- ⚡ Supplies with acid pack



Specifications

Nominal Voltage	12V
Cold Cranking Ampere (CCA)	95A
Nominal Capacity	9Ah
Container Material	ABS
Approx. Weight	2.99 kg (6.59lbs)
Acid Weight	0.76 kg (1.68lbs)
Layout	18
Terminal	F
Dimensions	Length 135 mm Width 75 mm Height 139 mm Total Height 139 mm

Size



Terminal

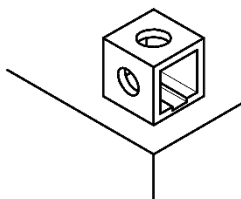

Position of terminals

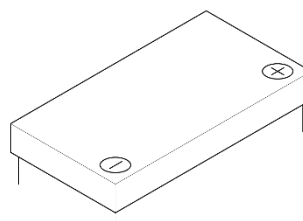

Degassing

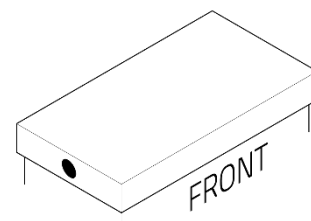

Alternatives

LP Batteries

Technology	Art. number
LFP	ML LFP7Z
GEL	-
SLA	MS LTX9A-3
DRY	-

Other Brands

IL LFP7Z

(Note) All above information shall be changed without prior notice, Landport Batteries reserves the right to explain and update the latest information.