

# LB12A-3 (12V 12Ah)



**Item Code:** MG LB12A-3  
**EAN:** 8717101024621

## Features

- ⚡ Nano-Gel technology
- ⚡ Vibration resistant
- ⚡ Starting performance even in cold weather
- ⚡ High capacity to support accessories
- ⚡ Can be installed in tilted position up to 90°
- ⚡ Low self-discharge
- ⚡ Factory activated, 100% maintenance free



## Specifications

<b>Nominal Voltage</b>	12V
<b>Cold Cranking Ampere (CCA)</b>	170A
<b>Nominal Capacity</b>	12Ah
<b>Container Material</b>	ABS
<b>Approx. Weight</b>	4.39 kg (9.68lbs)
<b>Layout</b>	0
<b>Terminal</b>	F
<b>Dimensions</b>	
	Length 134 mm
	Width 80 mm
	Height 161 mm
	Total Height 161 mm

Size



Position of Terminals

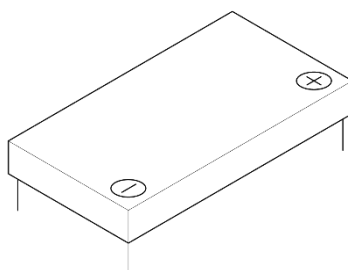

Terminal

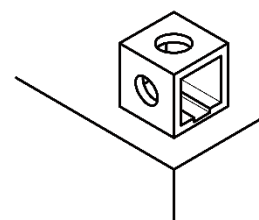

## Alternatives

### LP Batteries

Technology	Art. number
LFP	ML LFP14
GEL	-
SLA	MS LB12A-3
DRY	MD LB12AL-A - LB12AL-A2

### Other Brands

IL LFP14

(Note) All above information shall be changed without prior notice, Landport Batteries reserves the right to explain and update the latest information.