

LT9B-4 (12V 8Ah)



Item Code: MG LT9B-4
EAN: 8717101024683

Features

- ⚡ Nano-Gel technology
- ⚡ Vibration resistant
- ⚡ Starting performance even in cold weather
- ⚡ High capacity to support accessories
- ⚡ Can be installed in tilted position up to 90
- ⚡ Low self-discharge
- ⚡ Factory activated, 100% maintenance free



Specifications

Nominal Voltage	12V
Cold Cranking Ampere (CCA)	135A
Nominal Capacity	8Ah
Container Material	ABS
Approx. Weight	2.96 kg (6.53lbs)
Layout	1
Terminal	F
Dimensions	
Length	150 mm
Width	69 mm
Height	105 mm
Total Height	105 mm

Size



Position of Terminals

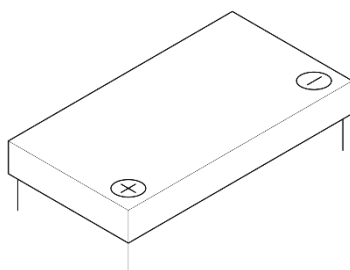

Terminal

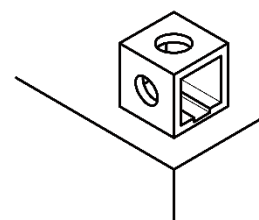

Alternatives

LP Batteries

Technology	Art. number
LFP	ML LFP9
GEL	-
SLA	MS LT9B-4
AGM	MA LT9B-BS

Other Brands

IA CT9B-BS - IS CT9B-4 - IL LFP9

(Note) All above information shall be changed without prior notice, Landport Batteries reserves the right to explain and update the latest information.