

LTX14-4 (12V 14Ah)



Item Code: MG LTX14-4
EAN: 8717101024690

Features

- ⚡ Nano-Gel technology
- ⚡ Vibration resistant
- ⚡ Starting performance even in cold weather
- ⚡ High capacity to support accessories
- ⚡ Can be installed in tilted position up to 90
- ⚡ Low self-discharge
- ⚡ Factory activated, 100% maintenance free



Specifications

Nominal Voltage	12V
Cold Cranking Ampere (CCA)	240A
Nominal Capacity	14Ah
Container Material	ABS
Approx. Weight	4.59 kg (10.12lbs)
Layout	1
Terminal	F
Dimensions	
Length	150 mm
Width	86 mm
Height	145 mm
Total Height	145 mm

Size

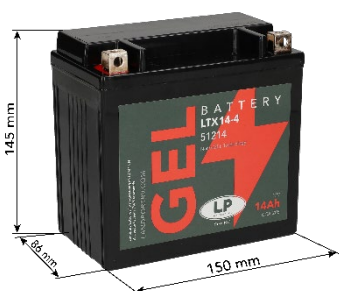

Position of Terminals

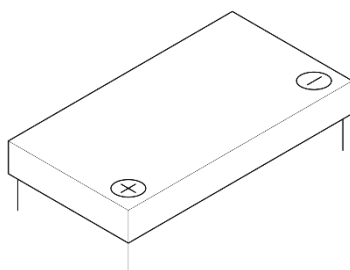

Terminal

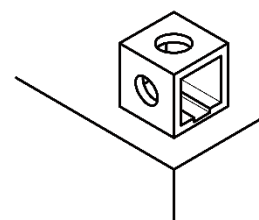

Alternatives

LP Batteries

Technology	Art. number
LFP	ML LFP14
HVT	MH HVT-8
SLA	MS LTX14-4
AGM	MA LTX14-BS

Other Brands

IA CTX14-BS - IS CTX14-BS - IH HVT-08 - IL LFP14

(Note) All above information shall be changed without prior notice, Landport Batteries reserves the right to explain and update the latest information.