

LTX20-3 (12V 20Ah)



Item Code: MG LTX20-3
 EAN: 8717101025048

Features

- ⚡ Nano-Gel technology
- ⚡ Vibration resistant
- ⚡ Starting performance even in cold weather
- ⚡ High capacity to support accessories
- ⚡ Can be installed in tilted position up to 90
- ⚡ Low self-discharge
- ⚡ Factory activated, 100% maintenance free



Specifications

Nominal Voltage	12V
Cold Cranking Ampere (CCA)	310A
Nominal Capacity	20Ah
Container Material	ABS
Approx. Weight	6.20 kg (13.67lbs)
Layout	0
Terminal	F
Dimensions	
	Length 175 mm
	Width 87 mm
	Height 154 mm
	Total Height 154 mm

Size

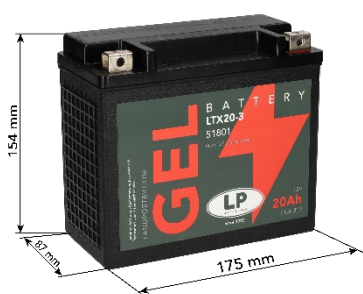

Position of Terminals

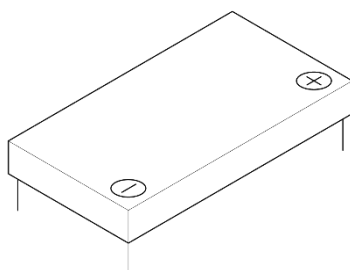

Terminal

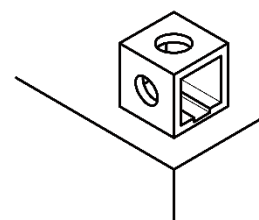

Alternatives

LP Batteries

Technology	Art. number
LFP	ML LFP20
HVT	MH HVT-1
SLA	MS LTX20-3
AGM	MA LTX20L-BS

Other Brands

IA CTX20L-BS - IH HVT-01 - IL LFP20

(Note) All above information shall be changed without prior notice, Landport Batteries reserves the right to explain and update the latest information.