

LTX20-4 (12V 20Ah)



Item Code: MG LTX20-4
EAN: 8717101024706

Features

- ⚡ Nano-Gel technology
- ⚡ Vibration resistant
- ⚡ Starting performance even in cold weather
- ⚡ High capacity to support accessories
- ⚡ Can be installed in tilted position up to 90°
- ⚡ Low self-discharge
- ⚡ Factory activated, 100% maintenance free



Specifications

Nominal Voltage	12V
Cold Cranking Ampere (CCA)	310A
Nominal Capacity	20Ah
Container Material	ABS
Approx. Weight	6.20 kg (13.67lbs)
Layout	1
Terminal	F
Dimensions	
Length	175 mm
Width	87 mm
Height	154 mm
Total Height	154 mm

Size

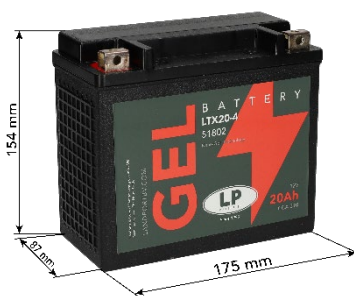

Position of Terminals

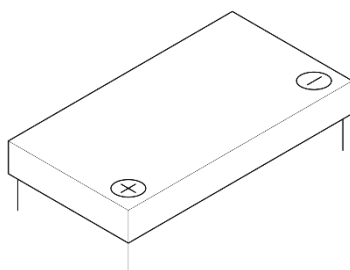

Terminal

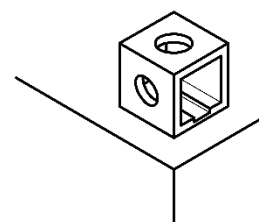

Alternatives

LP Batteries

Technology	Art. number
LFP	ML LFP20
GEL	-
SLA	MS LTX20-4
AGM	MA LTX20-BS

Other Brands

IA CTX20-BS - IL LFP20

(Note) All above information shall be changed without prior notice, Landport Batteries reserves the right to explain and update the latest information.