

# LTX5-3 (12V 5Ah)



**Item Code:** MG LTX5-3  
**EAN:** 8717101026687

## Features

- ⚡ Nano-Gel technology
- ⚡ Vibration resistant
- ⚡ Starting performance even in cold weather
- ⚡ High capacity to support accessories
- ⚡ Can be installed in tilted position up to 90°
- ⚡ Low self-discharge
- ⚡ Factory activated, 100% maintenance free



## Specifications

<b>Nominal Voltage</b>	12V
<b>Cold Cranking Ampere (CCA)</b>	90A
<b>Nominal Capacity</b>	5Ah
<b>Container Material</b>	ABS
<b>Approx. Weight</b>	1.80 kg (3.97lbs)
<b>Layout</b>	0
<b>Terminal</b>	F
<b>Dimensions</b>	
	Length 113 mm
	Width 69 mm
	Height 105 mm
	Total Height 105 mm

**Size**



**Position of Terminals**

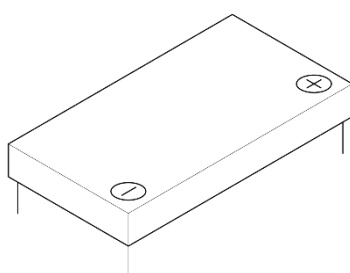

**Terminal**

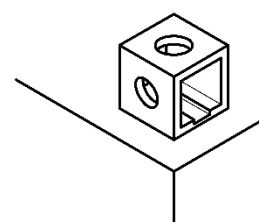

## Alternatives

### LP Batteries

Technology	Art. number
LFP	ML LFP5
GEL	-
SLA	-
AGM	MA LTX5L-BS

### Other Brands

IA CTX5L-BS - IL LFP5

**(Note)** All above information shall be changed without prior notice, Landport Batteries reserves the right to explain and update the latest information.