

LTZ10-S (12V 8.6Ah)



Item Code: MG LTZ10-S
 EAN: 8717101024744

Features

- ⚡ Nano-Gel technology
- ⚡ Vibration resistant
- ⚡ Starting performance even in cold weather
- ⚡ High capacity to support accessories
- ⚡ Can be installed in tilted position up to 90°
- ⚡ Low self-discharge
- ⚡ Factory activated, 100% maintenance free



Specifications

Nominal Voltage	12V
Cold Cranking Ampere (CCA)	190A
Nominal Capacity	8.60Ah
Container Material	ABS
Approx. Weight	2.77 kg (6.11lbs)
Layout	1
Terminal	F
Dimensions	
	Length 150 mm
	Width 86 mm
	Height 94 mm
	Total Height 94 mm

Size

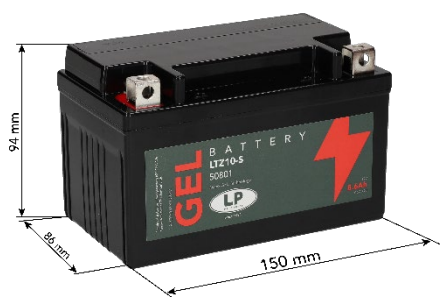

Position of Terminals

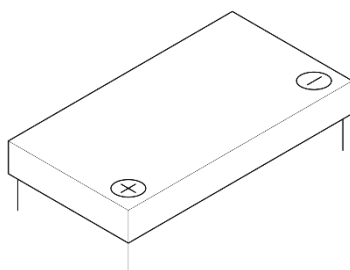

Terminal

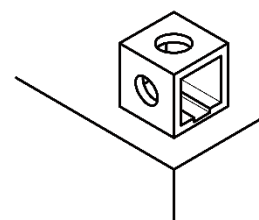

Alternatives

LP Batteries

Technology	Art. number
LFP	ML LFP14
GEL	-
SLA	MS LTZ10-S
AGM	MA LTZ10S-BS

Other Brands

IA CTZ10S-BS - IS CTZ10-S - IL LFP14

(Note) All above information shall be changed without prior notice, Landport Batteries reserves the right to explain and update the latest information.