

LTZ14-S (12V 11.2Ah)



Item Code: MG LTZ14-S
EAN: 8717101004470

Features

- ⚡ Nano-Gel technology
- ⚡ Vibration resistant
- ⚡ Starting performance even in cold weather
- ⚡ High capacity to support accessories
- ⚡ Can be installed in tilted position up to 90
- ⚡ Low self-discharge
- ⚡ Factory activated, 100% maintenance free



Specifications

Nominal Voltage	12V
Cold Cranking Ampere (CCA)	245A
Nominal Capacity	11.20Ah
Container Material	ABS
Approx. Weight	3.74 kg (8.25lbs)
Layout	1
Terminal	F
Dimensions	
Length	150 mm
Width	86 mm
Height	111 mm
Total Height	111 mm

Size



Position of Terminals

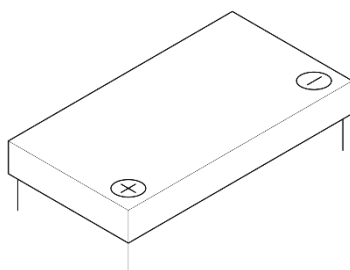

Terminal

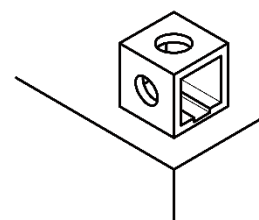

Alternatives

LP Batteries

Technology	Art. number
LFP	ML LFP14
GEL	-
SLA	MS LTZ14-S
AGM	MA LTZ14S-BS

Other Brands

IA CTZ14S-BS - IS CTZ14-S - IL LFP14

(Note) All above information shall be changed without prior notice, Landport Batteries reserves the right to explain and update the latest information.