

# LFP20 (12V 72Wh)



**Item Code:** ML LFP20  
**EAN:** 8717101005071

## Features

- ⚡ Lithium LiFePO4 technology
- ⚡ High CCA performance
- ⚡ Extreme cycle life (up to 2.000 charge cycles)
- ⚡ Ultra-light weight
- ⚡ Can be installed in any position
- ⚡ Low self-discharge



## Specifications

<b>Nominal Voltage</b>	12.8V
<b>Cold Cranking Ampere (CCA)</b>	420A
<b>Energy</b>	72Wh
<b>Rated Capacity (25°C)</b>	6.0Ah
<b>Container Material</b>	ABS
<b>Approx. Weight</b>	1.30 kg (2.86lbs)
<b>Layout</b>	25
<b>Terminal</b>	F
<b>Dimensions</b>	
	Length 165 mm
	Width 86 mm
	Height 130 mm
	Total Height 130 mm

Size



Position of Terminals

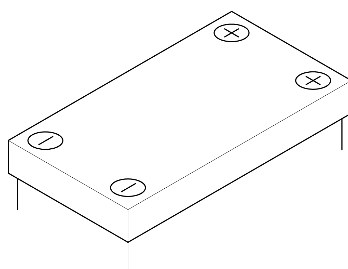

Terminal

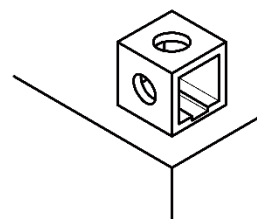

## Alternatives

### LP Batteries

Technology	Art. number
GEL	L50N18LA2 - LB16L-B - LB16B - LTX20-3 - LTX20-4
SLA	LTX18-3 - MB LTX24H-3 - LTX18-3 - LTX20-4 - LTX20-3
AGM	LTX18L-BS - MB LTX24HL-BS - LTX18L-BS - LTX20L-BS - LTX20HL-BS - LTX20-BS - LTX20H-BS - LTX20-BS - LTX20L-BS - LTX20HL-BS - LTX24HL-BS
DRY	L50N18LA2 - LB16L-B - LB16B - 12N18-3A - L50N18LA2 - LB16B-A

### Other Brands

CB16B-A - C50-N18L-A - CTX24HL-BS - CTX20L-BS - CTX20HL-BS - CTX20-BS - C50-N18L-A - CTX20L-BS - CTX20-BS

(Note) All above information shall be changed without prior notice, Landport Batteries reserves the right to explain and update the latest information.