

LFP30 (12V 96Wh)



Item Code: ML LFP30
 EAN: 8717101005088

Features

- ⚡ Lithium LiFePO4 technology
- ⚡ High CCA performance
- ⚡ Extreme cycle life (up to 2.000 charge cycles)
- ⚡ Ultra-light weight
- ⚡ Can be installed in any position
- ⚡ Low self-discharge



Specifications

Nominal Voltage	12.8V
Cold Cranking Ampere (CCA)	560A
Energy	96Wh
Rated Capacity (25°C)	8.00Ah
Container Material	ABS
Approx. Weight	1.50 kg (3.30lbs)
Layout	25
Terminal	F
Dimensions	
Length	165 mm
Width	86 mm
Height	130 mm
Total Height	130 mm

Size



Position of Terminals

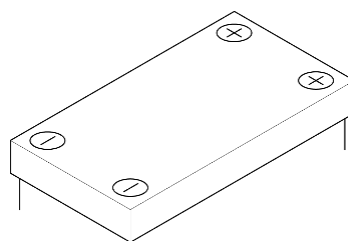

Terminal

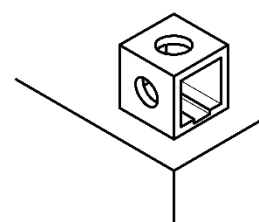

Alternatives

LP Batteries

Technology	Art. number
GEL	L60-N30L-A - L60-N30-A
SLA	U1-280 SLA - U1R-280 SLA - L60-N30-4 - L60-N30-3
SMF	U1-250MF - U1-300MF - U1-R300MF
DRY	12N24-3 - 12N24-3A - 12N24-4 - L60-N30-A - L60-N24A-LB - L60-N24L-A - L60-N30L-A - L60-N30L-B - L60-N30L-A - LB30CL-B - LB30L-B - 12N24-3 - 12N24-3A - 12N24-4 - 12N24-4A - L60-N24A-LB - L60-N24L-A - L60-N30-A - L60-N30L-A - LB30CL-B - LB30L-B - L60-N35L-A

Other Brands

C60-N24AL-B - C60-N24L-A - C60-N30L-A - C60-N30-A - CB30CL-B - CB30L-B - C60-N30L-A

(Note) All above information shall be changed without prior notice, Landport Batteries reserves the right to explain and update the latest information.