

# LFP7Z (12V 28.8Wh)



Item Code: ML LFP7Z  
 EAN: 8717101004821

## Features

- ⚡ Lithium LiFePO4 technology
- ⚡ High CCA performance
- ⚡ Extreme cycle life (up to 2.000 charge cycles)
- ⚡ Ultra-light weight
- ⚡ Can be installed in any position
- ⚡ Low self-discharge



## Specifications

Nominal Voltage	12.8 V	
Cold Cranking Ampere (CCA)	170A	
Energy	28.8Wh	
Rated Capacity (25°C)	2.4Ah	
Container Material	ABS	
Approx. Weight	0.60 kg (1.32lbs)	
Layout	25	
Terminal	F	
Dimensions	Length	107 mm
	Width	56 mm
	Height	85 mm
	Total Height	85 mm

Size



Position of Terminals

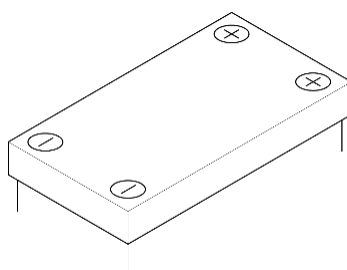

Terminal

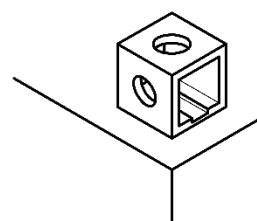

## Alternatives

### LP Batteries

Technology	Art. number
GEL	LB9B - LTX7A-4 - LTZ7-S
SLA	LTX9A-3 - LTX7A-4 - LTZ7-S
AGM	LTX9A-BS - LTX7A-BS - LTZ7S-BS
DRY	LB9L-B - LB9B - LB9L-A2 - LB9A-A - LB9L-B - LB9B

### Other Brands

CTX7A-BS - CTZ7S-BS - CTX7A-BS - CTZ7-S - CTX7A-BS - CTZ7-S

(Note) All above information shall be changed without prior notice, Landport Batteries reserves the right to explain and update the latest information.