

LFP7 (12V 24Wh)



Item Code: ML LFP7
 EAN: 8717101004562

Features

- ⚡ Lithium LiFePO4 technology
- ⚡ High CCA performance
- ⚡ Extreme cycle life (up to 2.000 charge cycles)
- ⚡ Ultra-light weight
- ⚡ Can be installed in any position
- ⚡ Low self-discharge



Specifications

Nominal Voltage	12.8 V	
Cold Cranking Ampere (CCA)	140A	
Energy	24Wh	
Rated Capacity (25°C)	2.0Ah	
Container Material	ABS	
Approx. Weight	0.50 kg (1.10lbs)	
Layout	25	
Terminal	F	
Dimensions	Length	107 mm
	Width	56 mm
	Height	85 mm
	Total Height	85 mm

Size



Position of Terminals

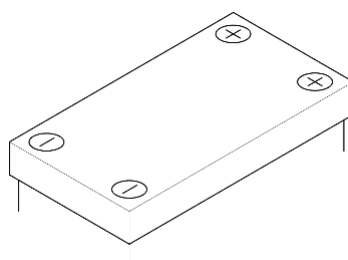

Terminal

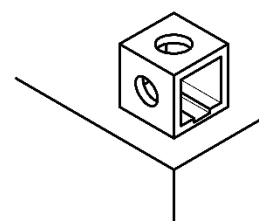

Alternatives

LP Batteries

Technology	Art. number
GEL	LTX7-3
SLA	LB7-4 - LB7-3 - LTX7-3
AGM	LTX7L-BS
DRY	LB7L-B - LB7-A - 12N7-3B-2 - 12N7-4B - LB7C-A - LB7L-B - LB7-A - LB7C-A

Other Brands

IS CTX7L-BS - IG CTX7L-BS

(Note) All above information shall be changed without prior notice, Landport Batteries reserves the right to explain and update the latest information.