

LFP9 (12V 36Wh)



Item Code: ML LFP9
EAN: 8717101005040

Features

- ⚡ Lithium LiFePO4 technology
- ⚡ High CCA performance
- ⚡ Extreme cycle life (up to 2.000 charge cycles)
- ⚡ Ultra-light weight
- ⚡ Can be installed in any position
- ⚡ Low self-discharge



Specifications

Nominal Voltage	12.8 V
Cold Cranking Ampere (CCA)	210A
Energy	36Wh
Rated Capacity (25°C)	3.0Ah
Container Material	ABS
Approx. Weight	0.70 kg (1.54lbs)
Layout	25
Terminal	F
Dimensions	
	Length 134 mm
	Width 65 mm
	Height 92 mm
	Total Height 92 mm

Size



Position of Terminals

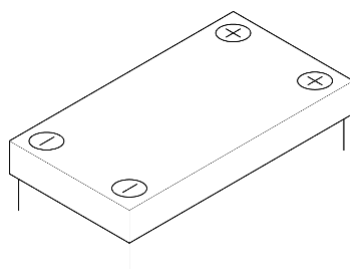

Terminal

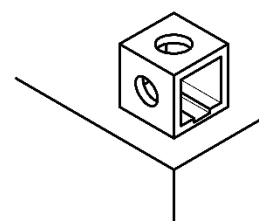

Alternatives

LP Batteries

Technology	Art. number
GEL	LB9B - LTX9-4 - LT7B-4 - LT9B-4
SLA	LTX9A-4 - LT7B-4 - LT9B-4 - LTX9-4
AGM	LTX9A-BS - LTX9-BS - LT7B-BS - LT9B-BS
DRY	LB9B

Other Brands

CTX9A-BS - CTX9-BS - CT7B-BS - CT9B-BS - CT7B-4 - CT9B-4 - CTX9-BS - 12N9-4B-1 - CTX9-BS - CT7B-4 - CT9B-4

(Note) All above information shall be changed without prior notice, Landport Batteries reserves the right to explain and update the latest information.