

# LB10-3 (12V 10Ah)



Item Code: MS LB10-3  
 EAN: 8717101014196

## Features

- ⚡ Sealed Maintenance Free Battery
- ⚡ Absorbent Glass Mat technology
- ⚡ Advanced starting power
- ⚡ Can be installed in tilted position up to 90°
- ⚡ Factory activated, 100% maintenance free.



## Specifications

Nominal Voltage	12V	
Cold Cranking Ampere (CCA)	135A	
Nominal Capacity	10Ah	
Container Material	ABS	
Approx. Weight	3.93 kg (8.66lbs)	
Layout	0	
Terminal	F	
Dimensions	Length	135 mm
	Width	90 mm
	Height	145 mm
	Total Height	145 mm

Size



Position of Terminals

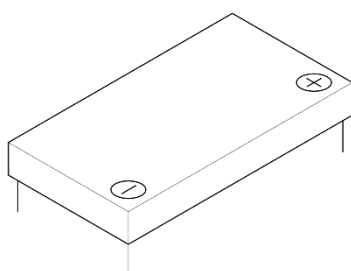

Terminal

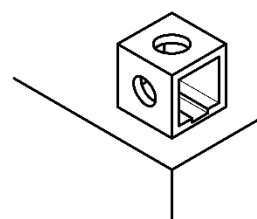

## Alternatives

### LP Batteries

Technology	Art. number
LFP	ML LFP14
GEL	MG LB10-3
AGM	-
DRY	MD LB10L-A2 - LB10L-B - LB10L-B2

### Other Brands

IL LFP14

(Note) All above information shall be changed without prior notice, Landport Batteries reserves the right to explain and update the latest information.