

LB16CL-B (S) (12V 19Ah)



Item Code: MS LB16CL-B (S)
EAN: 8717101013922

Features

- ⚡ Sealed Maintenance Free Battery
- ⚡ Absorbent Glass Mat technology
- ⚡ Advanced starting power
- ⚡ Can be installed in tilted position up to 90°
- ⚡ Factory activated, 100% maintenance free.



Specifications

Nominal Voltage	12V
Cold Cranking Ampere (CCA)	260A
Nominal Capacity	19Ah
Container Material	ABS
Approx. Weight	6.77 kg (14.93lbs)
Layout	0
Terminal	F
Dimensions	
	Length 175 mm
	Width 100 mm
	Height 174 mm
	Total Height 174 mm

Size



Position of Terminals

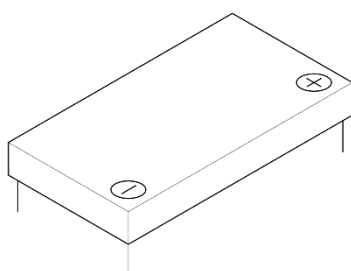

Terminal

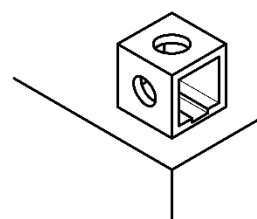

Alternatives

LP Batteries

Technology	Art. number
LFP	ML LFP16
GEL	-
AGM	-
DRY	MD LB16CL-B

Other Brands

IC CB16CL-B - IL LFP16

(Note) All above information shall be changed without prior notice, Landport Batteries reserves the right to explain and update the latest information.