

LT12B-4 (12V 10Ah)



Item Code: MS LT12B-4
EAN: 8717101002643

Features

- ⚡ Sealed Maintenance Free Battery
- ⚡ Absorbent Glass Mat technology
- ⚡ Advanced starting power
- ⚡ Can be installed in tilted position up to 90°
- ⚡ Factory activated, 100% maintenance free.



Specifications

Nominal Voltage	12V
Cold Cranking Ampere (CCA)	160A
Nominal Capacity	10Ah
Container Material	ABS
Approx. Weight	3.60 kg (7.94lbs)
Layout	1
Terminal	F
Dimensions	
	Length 150 mm
	Width 70 mm
	Height 130 mm
	Total Height 130 mm

Size



Position of Terminals

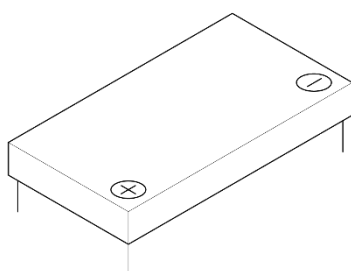

Terminal

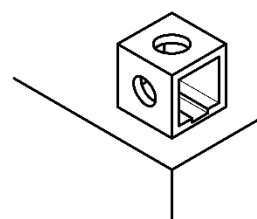

Alternatives

LP Batteries

Technology	Art. number
LFP	ML LFP14
GEL	MG LT12B-4
AGM	MA LT12B-BS
DRY	-

Other Brands

IA CT12B-BS - IG CT12B-4 - IL LFP14

(Note) All above information shall be changed without prior notice, Landport Batteries reserves the right to explain and update the latest information.