

# LT7B-4 (12V 6.5Ah)



**Item Code:** MS LT7B-4  
**EAN:** 8717101002322

## Features

- ⚡ Sealed Maintenance Free Battery
- ⚡ Absorbent Glass Mat technology
- ⚡ Advanced starting power
- ⚡ Can be installed in tilted position up to 90°
- ⚡ Factory activated, 100% maintenance free.

## Specifications

<b>Nominal Voltage</b>	12V								
<b>Cold Cranking Ampere (CCA)</b>	110A								
<b>Nominal Capacity</b>	6.5Ah								
<b>Container Material</b>	ABS								
<b>Approx. Weight</b>	2.06 kg (4.54lbs)								
<b>Layout</b>	1								
<b>Terminal</b>	F								
<b>Dimensions</b>	<table border="0"> <tr> <td>Length</td> <td>150 mm</td> </tr> <tr> <td>Width</td> <td>65 mm</td> </tr> <tr> <td>Height</td> <td>93 mm</td> </tr> <tr> <td>Total Height</td> <td>93 mm</td> </tr> </table>	Length	150 mm	Width	65 mm	Height	93 mm	Total Height	93 mm
Length	150 mm								
Width	65 mm								
Height	93 mm								
Total Height	93 mm								

**Size**  
-

**Position of Terminals**

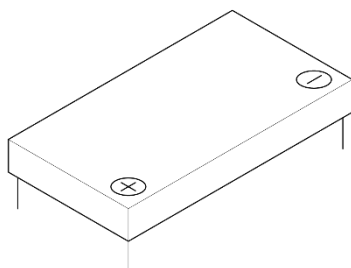

**Terminal**

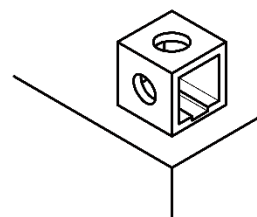

## Alternatives

### LP Batteries

Technology	Art. number
LFP	ML LFP7
GEL	-
AGM	-
DRY	MD LB7-A

### Other Brands

IC CB7-A - IL LFP7

**(Note)** All above information shall be changed without prior notice, Landport Batteries reserves the right to explain and update the latest information.