

LT9B-4 (12V 8Ah)



Item Code: MS LT9B-4
EAN: 8717101008614

Features

- ⚡ Sealed Maintenance Free Battery
- ⚡ Absorbent Glass Mat technology
- ⚡ Advanced starting power
- ⚡ Can be installed in tilted position up to 90°
- ⚡ Factory activated, 100% maintenance free.



Specifications

Nominal Voltage	12V
Cold Cranking Ampere (CCA)	120A
Nominal Capacity	8Ah
Container Material	ABS
Approx. Weight	2.82 kg (6.22lbs)
Layout	1
Terminal	F
Dimensions	
	Length 150 mm
	Width 70 mm
	Height 104 mm
	Total Height 104 mm

Size



Position of Terminals

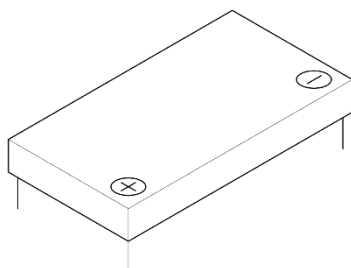

Terminal

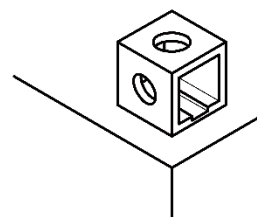

Alternatives

LP Batteries

Technology	Art. number
LFP	ML LFP9
GEL	MG LT9B-4
AGM	MA LT9B-BS
DRY	-

Other Brands

IA CT9B-BS - IG CT9B-4 - IL LFP9

(Note) All above information shall be changed without prior notice, Landport Batteries reserves the right to explain and update the latest information.