

# LTX12A-4 (12V 10Ah)



Item Code: MS LTX12A-4  
 EAN: 8717101021255

## Features

- ⚡ Sealed Maintenance Free Battery
- ⚡ Absorbent Glass Mat technology
- ⚡ Advanced starting power
- ⚡ Can be installed in tilted position up to 90°
- ⚡ Factory activated, 100% maintenance free.



## Specifications

Nominal Voltage	12V	
Cold Cranking Ampere (CCA)	175A	
Nominal Capacity	10Ah	
Container Material	ABS	
Approx. Weight	3.40 kg (7.50lbs)	
Layout	1	
Terminal	F	
Dimensions	Length	151 mm
	Width	87 mm
	Height	105 mm
	Total Height	105 mm

Size



Position of Terminals

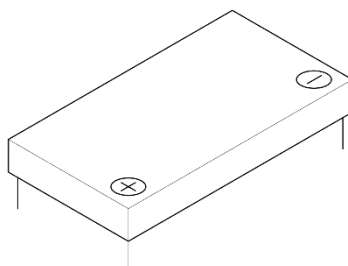

Terminal

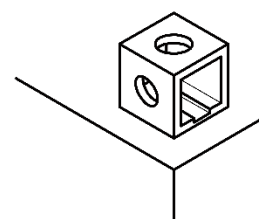

## Alternatives

### LP Batteries

Technology	Art. number
LFP	ML LFP14
GEL	-
AGM	MA LT12A-BS
DRY	-

### Other Brands

IG CTX12A-BS - IL LFP14

(Note) All above information shall be changed without prior notice, Landport Batteries reserves the right to explain and update the latest information.