

LTX14-3 (12V 12Ah)



Item Code: MS LTX14-3
EAN: 8717101023075

Features

- ⚡ Sealed Maintenance Free Battery
- ⚡ Absorbent Glass Mat technology
- ⚡ Advanced starting power
- ⚡ Can be installed in tilted position up to 90°
- ⚡ Factory activated, 100% maintenance free.



Specifications

Nominal Voltage	12V
Cold Cranking Ampere (CCA)	200A
Nominal Capacity	12Ah
Container Material	ABS
Approx. Weight	4.35 kg (9.59lbs)
Layout	0
Terminal	F
Dimensions	
	Length 151 mm
	Width 87 mm
	Height 145 mm
	Total Height 145 mm

Size



Position of Terminals

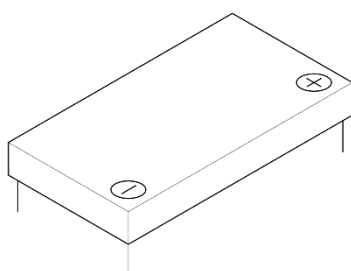

Terminal

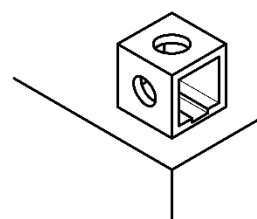

Alternatives

LP Batteries

Technology	Art. number
LFP	ML LFP14
HVT	MH HVT-3
AGM	MA LTX14L-BS
DRY	-

Other Brands

(Note) All above information shall be changed without prior notice, Landport Batteries reserves the right to explain and update the latest information.