

# LTX14-4 (12V 12Ah)



Item Code: MS LTX14-4  
 EAN: 8717101023082

## Features

- ⚡ Sealed Maintenance Free Battery
- ⚡ Absorbent Glass Mat technology
- ⚡ Advanced starting power
- ⚡ Can be installed in tilted position up to 90°
- ⚡ Factory activated, 100% maintenance free.



## Specifications

Nominal Voltage	12V	
Cold Cranking Ampere (CCA)	200A	
Nominal Capacity	12Ah	
Container Material	ABS	
Approx. Weight	4.35 kg (9.59lbs)	
Layout	1	
Terminal	F	
Dimensions	Length	151 mm
	Width	87 mm
	Height	145 mm
	Total Height	145 mm

Size

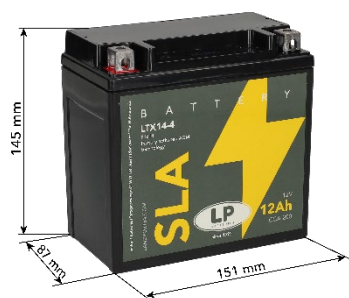

Position of Terminals

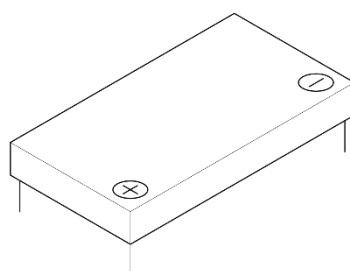

Terminal

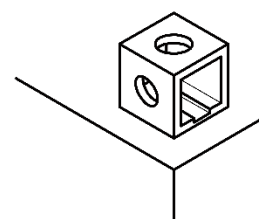

## Alternatives

### LP Batteries

Technology	Art. number
LFP	ML LFP14
GEL	MG LTX14-4
HVT	MH HVT-8
AGM	MA LTX14-BS

### Other Brands

IA CTX14-BS - IH HVT-08 - IG CTX14-BS - IL LFP14

(Note) All above information shall be changed without prior notice, Landport Batteries reserves the right to explain and update the latest information.