

# LTX14AH-4 (12V 14Ah)



**Item Code:** MS LTX14AH-4  
**EAN:** 8717101023181

## Features

- ⚡ Sealed Maintenance Free Battery
- ⚡ Absorbent Glass Mat technology
- ⚡ Advanced starting power
- ⚡ Can be installed in tilted position up to 90°
- ⚡ Factory activated, 100% maintenance free.



## Specifications

<b>Nominal Voltage</b>	12V
<b>Cold Cranking Ampere (CCA)</b>	200A
<b>Nominal Capacity</b>	14Ah
<b>Container Material</b>	ABS
<b>Approx. Weight</b>	4.70 kg (10.36lbs)
<b>Layout</b>	1
<b>Terminal</b>	F
<b>Dimensions</b>	
	Length 135 mm
	Width 90 mm
	Height 168 mm
	Total Height 168 mm

Size



Position of Terminals

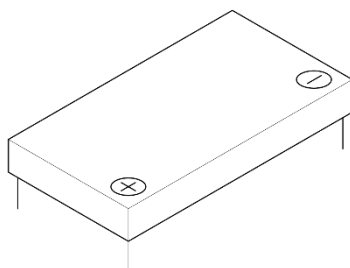

Terminal

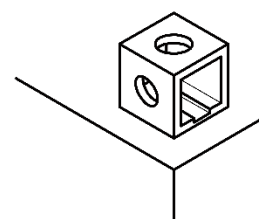

## Alternatives

### LP Batteries

<b>Technology</b>	<b>Art. number</b>
LFP	ML LFP14
GEL	-
AGM	MA LTX14AH-BS
DRY	MD LB14-A2 - LB14-B2

### Other Brands

IL LFP14

(Note) All above information shall be changed without prior notice, Landport Batteries reserves the right to explain and update the latest information.