

LTX20-3 (12V 18Ah)



Item Code: MS LTX20-3
 EAN: 8717101023051

Features

- ⚡ Sealed Maintenance Free Battery
- ⚡ Absorbent Glass Mat technology
- ⚡ Advanced starting power
- ⚡ Can be installed in tilted position up to 90°
- ⚡ Factory activated, 100% maintenance free.



Specifications

Nominal Voltage	12V	
Cold Cranking Ampere (CCA)	270A	
Nominal Capacity	18Ah	
Container Material	ABS	
Approx. Weight	5.80 kg (12.79lbs)	
Layout	0	
Terminal	F	
Dimensions	Length	176.50 mm
	Width	87.50 mm
	Height	154 mm
	Total Height	154 mm

Size



Position of Terminals

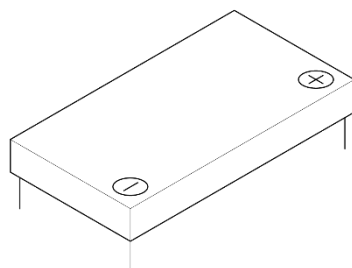

Terminal

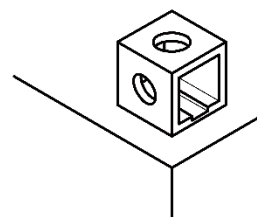

Alternatives

LP Batteries

Technology	Art. number
LFP	ML LFP20
GEL	MG LTX20-3
HVT	MH HVT-1
AGM	MA LTX20L-BS - LTX20HL-BS

Other Brands

IH HVT-01 - IG CTX20L-BS - IL LFP20

(Note) All above information shall be changed without prior notice, Landport Batteries reserves the right to explain and update the latest information.