

LTX20CH-4 (12V 19Ah)



Item Code: MS LTX20CH-4
EAN: 8717101023112

Features

- ⚡ Sealed Maintenance Free Battery
- ⚡ Absorbent Glass Mat technology
- ⚡ Advanced starting power
- ⚡ Can be installed in tilted position up to 90°
- ⚡ Factory activated, 100% maintenance free.



Specifications

Nominal Voltage	12V
Cold Cranking Ampere (CCA)	275A
Nominal Capacity	19Ah
Container Material	ABS
Approx. Weight	5.75 kg (12.68lbs)
Layout	1
Terminal	F
Dimensions	
	Length 151 mm
	Width 87 mm
	Height 162 mm
	Total Height 162 mm

Size

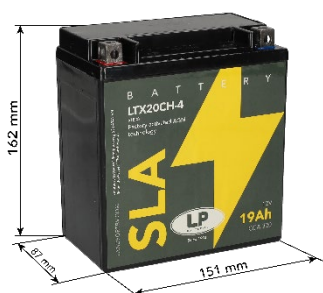

Position of Terminals

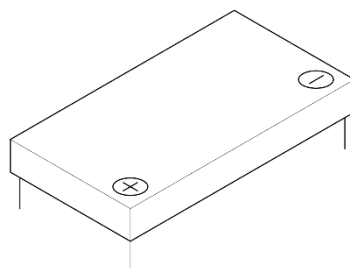

Terminal

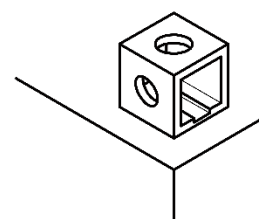

Alternatives

LP Batteries

Technology	Art. number
LFP	ML LFP14
GEL	-
AGM	MA LTX20CH-BS
DRY	-

Other Brands

IL LFP14

(Note) All above information shall be changed without prior notice, Landport Batteries reserves the right to explain and update the latest information.