

# LTX24H-3 (12V 21Ah)



**Item Code:** MS LTX24H-3  
**EAN:** 8717101023068

## Features

- ⚡ Sealed Maintenance Free Battery
- ⚡ Absorbent Glass Mat technology
- ⚡ Advanced starting power
- ⚡ Can be installed in tilted position up to 90°
- ⚡ Factory activated, 100% maintenance free.



## Specifications

|                                   |                     |
|-----------------------------------|---------------------|
| <b>Nominal Voltage</b>            | 12V                 |
| <b>Cold Cranking Ampere (CCA)</b> | 320A                |
| <b>Nominal Capacity</b>           | 21Ah                |
| <b>Container Material</b>         | ABS                 |
| <b>Approx. Weight</b>             | 7.32 kg (16.14lbs)  |
| <b>Layout</b>                     | 0                   |
| <b>Terminal</b>                   | F                   |
| <b>Dimensions</b>                 |                     |
|                                   | Length 205 mm       |
|                                   | Width 87 mm         |
|                                   | Height 162 mm       |
|                                   | Total Height 162 mm |

Size



Position of Terminals

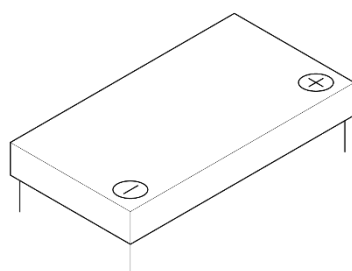

Terminal

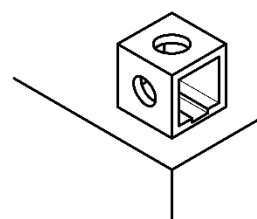

## Alternatives

### LP Batteries

| Technology | Art. number   |
|------------|---------------|
| LFP        | ML LFP20      |
| HVT        | MH HVT-6      |
| AGM        | MA LTX24HL-BS |
| DRY        | MD L50N18LA2  |

### Other Brands

(Note) All above information shall be changed without prior notice, Landport Batteries reserves the right to explain and update the latest information.