

LTX5-3 (12V 4Ah)



Item Code: MS LTX5-3
EAN: 8717101021262

Features

- ⚡ Sealed Maintenance Free Battery
- ⚡ Absorbent Glass Mat technology
- ⚡ Advanced starting power
- ⚡ Can be installed in tilted position up to 90°
- ⚡ Factory activated, 100% maintenance free.



Specifications

Nominal Voltage	12V	
Cold Cranking Ampere (CCA)	80A	
Nominal Capacity	4Ah	
Container Material	ABS	
Approx. Weight	1.66 kg (3.65lbs)	
Layout	0	
Terminal	F	
Dimensions	Length	113 mm
	Width	70 mm
	Height	105 mm
	Total Height	105 mm

Size



Position of Terminals

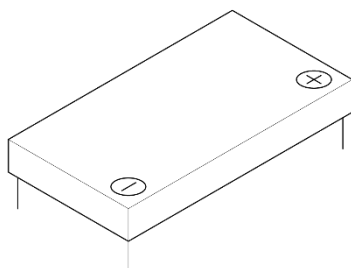

Terminal

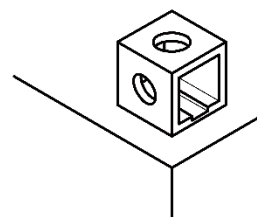

Alternatives

LP Batteries

Technology	Art. number
LFP	ML LFP5
GEL	MG LTX5-3
AGM	MA LTX5L-BS
DRY	-

Other Brands

IA CTX5L-BS - IG CTX5L-BS - IL LFP5

(Note) All above information shall be changed without prior notice, Landport Batteries reserves the right to explain and update the latest information.