

LTX7A-4 (12V 6Ah)



Item Code: MS LTX7A-4
 EAN: 8717101003015

Features

- ⚡ Sealed Maintenance Free Battery
- ⚡ Absorbent Glass Mat technology
- ⚡ Advanced starting power
- ⚡ Can be installed in tilted position up to 90°
- ⚡ Factory activated, 100% maintenance free.



Specifications

Nominal Voltage	12V
Cold Cranking Ampere (CCA)	105A
Nominal Capacity	6Ah
Container Material	ABS
Approx. Weight	2.23 kg (4.92lbs)
Layout	1
Terminal	F
Dimensions	
	Length 149.20 mm
	Width 83.60 mm
	Height 94 mm
	Total Height 94 mm

Size

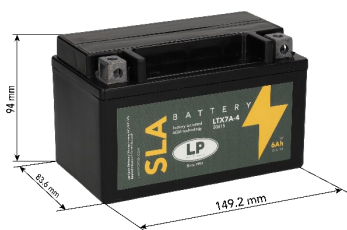

Position of Terminals

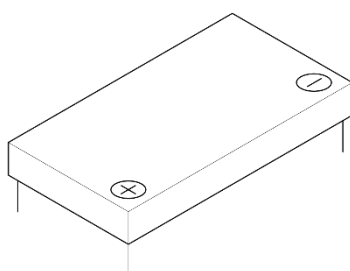

Terminal

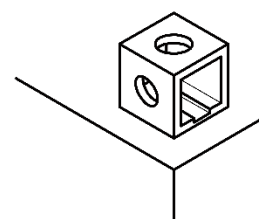

Alternatives

LP Batteries

Technology	Art. number
LFP	ML LFP7Z
GEL	MG LTX7A-4
AGM	MA LTX7A-BS
DRY	-

Other Brands

IA CTX7A-BS - IG CTX7A-BS - IL LFP7Z

(Note) All above information shall be changed without prior notice, Landport Batteries reserves the right to explain and update the latest information.