

LTX9-4 (12V 8Ah)



Item Code: MS LTX9-4
 EAN: 8717101003022

Features

- ⚡ Sealed Maintenance Free Battery
- ⚡ Absorbent Glass Mat technology
- ⚡ Advanced starting power
- ⚡ Can be installed in tilted position up to 90°
- ⚡ Factory activated, 100% maintenance free.



Specifications

Nominal Voltage	12V	
Cold Cranking Ampere (CCA)	135A	
Nominal Capacity	8Ah	
Container Material	ABS	
Approx. Weight	2.78 kg (6.13lbs)	
Layout	1	
Terminal	F	
Dimensions	Length	149.20 mm
	Width	83.60 mm
	Height	104 mm
	Total Height	104 mm

Size



Position of Terminals

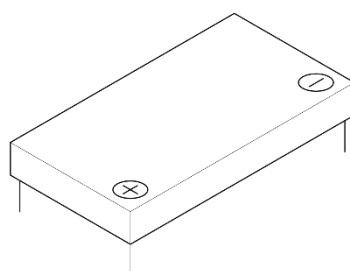

Terminal

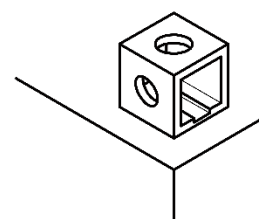

Alternatives

LP Batteries

Technology	Art. number
LFP	ML LFP9
GEL	MG LTX9-4
AGM	MA LTX9-BS
DRY	-

Other Brands

IA CTX9-BS - IG CTX9-BS - IL LFP9

(Note) All above information shall be changed without prior notice, Landport Batteries reserves the right to explain and update the latest information.