

# LTZ10-S (12V 8.60Ah)



**Item Code:** MS LTZ10-S  
**EAN:** 8717101011935

## Features

- ⚡ Sealed Maintenance Free Battery
- ⚡ Absorbent Glass Mat technology
- ⚡ Advanced starting power
- ⚡ Can be installed in tilted position up to 90°
- ⚡ Factory activated, 100% maintenance free.



## Specifications

<b>Nominal Voltage</b>	12V	
<b>Cold Cranking Ampere (CCA)</b>	190A	
<b>Nominal Capacity</b>	8.60Ah	
<b>Container Material</b>	ABS	
<b>Approx. Weight</b>	2.90 kg (6.39lbs)	
<b>Layout</b>	1	
<b>Terminal</b>	F	
<b>Dimensions</b>	Length	151 mm
	Width	87 mm
	Height	95 mm
	Total Height	95 mm

**Size**



**Position of Terminals**

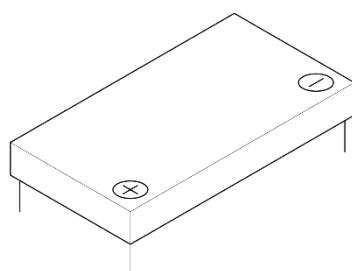

**Terminal**

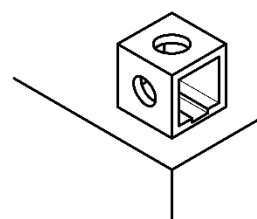

## Alternatives

### LP Batteries

Technology	Art. number
LFP	ML LFP14
GEL	MG LTZ10-S
AGM	MA LTZ10S-BS
DRY	-

### Other Brands

IA CTZ10S-BS - IG CT10B-4 - IL LFP14

(Note) All above information shall be changed without prior notice, Landport Batteries reserves the right to explain and update the latest information.