

LTZ12-S (12V 11Ah)



Item Code: MS LTZ12-S
 EAN: 8717101011942

Features

- ⚡ Sealed Maintenance Free Battery
- ⚡ Absorbent Glass Mat technology
- ⚡ Advanced starting power
- ⚡ Can be installed in tilted position up to 90°
- ⚡ Factory activated, 100% maintenance free.



Specifications

Nominal Voltage	12V	
Cold Cranking Ampere (CCA)	210A	
Nominal Capacity	11Ah	
Container Material	ABS	
Approx. Weight	3.50 kg (7.71lbs)	
Layout	1	
Terminal	F	
Dimensions	Length	151 mm
	Width	87 mm
	Height	110 mm
	Total Height	110 mm

Size



Position of Terminals

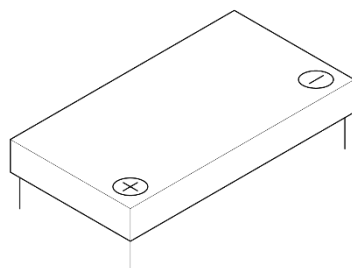

Terminal

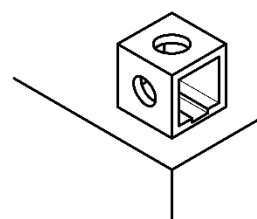

Alternatives

LP Batteries

Technology	Art. number
LFP	ML LFP14
GEL	MG LTZ12-S
SLA	MS LTX12A-4
AGM	MA LT12A-BS

Other Brands

IA CTX12A-BS - IS CTZ12-S - IG CTZ12-S - IL LFP14

(Note) All above information shall be changed without prior notice, Landport Batteries reserves the right to explain and update the latest information.