

# LTZ14-S (12V 11.20Ah)



Item Code: MS LTZ14-S  
 EAN: 8717101011959

## Features

- ⚡ Sealed Maintenance Free Battery
- ⚡ Absorbent Glass Mat technology
- ⚡ Advanced starting power
- ⚡ Can be installed in tilted position up to 90°
- ⚡ Factory activated, 100% maintenance free.



## Specifications

|                            |                   |        |
|----------------------------|-------------------|--------|
| Nominal Voltage            | 12V               |        |
| Cold Cranking Ampere (CCA) | 220A              |        |
| Nominal Capacity           | 11.20Ah           |        |
| Container Material         | ABS               |        |
| Approx. Weight             | 3.50 kg (7.71lbs) |        |
| Layout                     | 1                 |        |
| Terminal                   | F                 |        |
| Dimensions                 | Length            | 151 mm |
|                            | Width             | 87 mm  |
|                            | Height            | 110 mm |
|                            | Total Height      | 110 mm |

Size



Position of Terminals

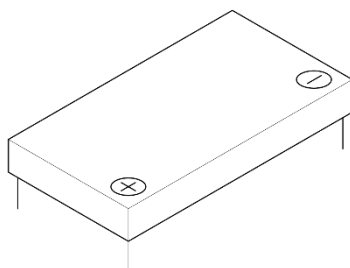

Terminal

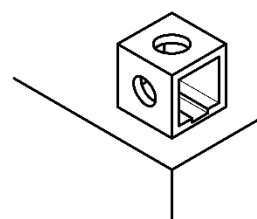

## Alternatives

### LP Batteries

| Technology | Art. number  |
|------------|--------------|
| LFP        | ML LFP14     |
| GEL        | MG LTZ14-S   |
| AGM        | MA LTZ14S-BS |
| DRY        | -            |

### Other Brands

IA CTZ14S-BS - IG CTZ14-S - IL LFP14

(Note) All above information shall be changed without prior notice, Landport Batteries reserves the right to explain and update the latest information.