

# LTZ7-S (12V 6Ah)



Item Code: MS LTZ7-S  
 EAN: 8717101011928

## Features

- ⚡ Sealed Maintenance Free Battery
- ⚡ Absorbent Glass Mat technology
- ⚡ Advanced starting power
- ⚡ Can be installed in tilted position up to 90°
- ⚡ Factory activated, 100% maintenance free.



## Specifications

Nominal Voltage	12V
Cold Cranking Ampere (CCA)	130A
Nominal Capacity	6Ah
Container Material	ABS
Approx. Weight	2.05 kg (4.52lbs)
Layout	0
Terminal	F
Dimensions	
	Length 113 mm
	Width 70 mm
	Height 107 mm
	Total Height 107 mm

Size



Position of Terminals

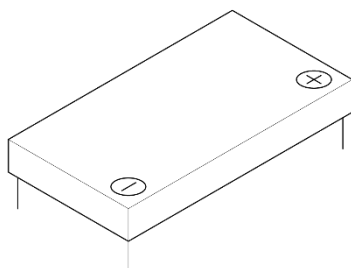

Terminal

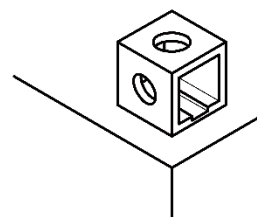

## Alternatives

### LP Batteries

Technology	Art. number
LFP	ML LFP7Z
GEL	MG LTZ7-S
AGM	MA LTZ7S-BS
DRY	

### Other Brands

IA CTZ7S-BS - IG CTZ7-S - IL LFP7Z

(Note) All above information shall be changed without prior notice, Landport Batteries reserves the right to explain and update the latest information.