

LTZ7V (12V 7Ah)



Item Code: MS LTZ7V
 EAN: 8717101000281

Features

- ⚡ Sealed Maintenance Free Battery
- ⚡ Absorbent Glass Mat technology
- ⚡ Advanced starting power
- ⚡ Can be installed in tilted position up to 90°
- ⚡ Factory activated, 100% maintenance free.



Specifications

Nominal Voltage	12V	
Cold Cranking Ampere (CCA)	110A	
Nominal Capacity	7Ah	
Container Material	ABS	
Approx. Weight	2.32 kg (5.11lbs)	
Layout	0	
Terminal	F	
Dimensions	Length	113 mm
	Width	70 mm
	Height	120 mm
	Total Height	120 mm

Size
-

Position of Terminals

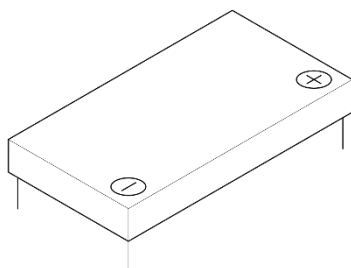

Terminal

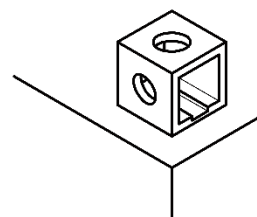

Alternatives

LP Batteries

Technology	Art. number
GEL	-
SLA	-
AGM	-
DRY	-

Other Brands

(Note) All above information shall be changed without prior notice, Landport Batteries reserves the right to explain and update the latest information.