

# LTZ8V (12V 7Ah)



Item Code: MS LTZ8V  
 EAN: 8717101000519

## Features

- ⚡ Sealed Maintenance Free Battery
- ⚡ Absorbent Glass Mat technology
- ⚡ Advanced starting power
- ⚡ Can be installed in tilted position up to 90°
- ⚡ Factory activated, 100% maintenance free.



## Specifications

Nominal Voltage	12V
Cold Cranking Ampere (CCA)	120A
Nominal Capacity	7Ah
Container Material	ABS
Approx. Weight	2.40 kg (5.00lbs)
Layout	0
Terminal	F
Dimensions	
	Length 113 mm
	Width 70 mm
	Height 128 mm
	Total Height 128 mm

Size



Position of Terminals

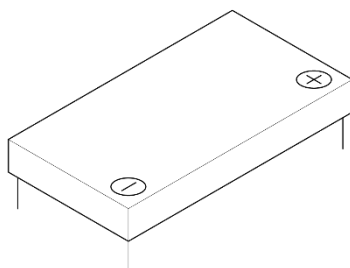

Terminal

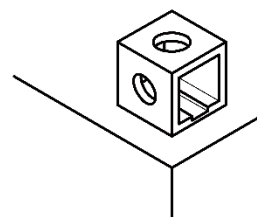

## Alternatives

### LP Batteries

Technology	Art. number
GEL	-
SLA	-
AGM	-
DRY	-

### Other Brands

(Note) All above information shall be changed without prior notice, Landport Batteries reserves the right to explain and update the latest information.