

SLA 12-4S (12V 5Ah)



Item Code: MS SLA 12-4S
EAN: 8717101022375

Features

- ⚡ Sealed Maintenance Free Battery
- ⚡ Absorbent Glass Mat technology
- ⚡ Advanced starting power
- ⚡ Can be installed in tilted position up to 90°
- ⚡ Factory activated, 100% maintenance free.



Specifications

Nominal Voltage	12V
Cold Cranking Ampere (CCA)	55A
Nominal Capacity	5Ah
Container Material	ABS
Approx. Weight	1.52 kg (3.35lbs)
Layout	0
Terminal	F
Dimensions	
	Length 113 mm
	Width 70 mm
	Height 85 mm
	Total Height 85 mm

Size



Position of Terminals

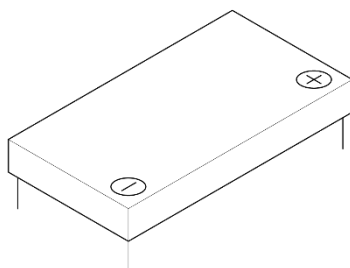

Terminal

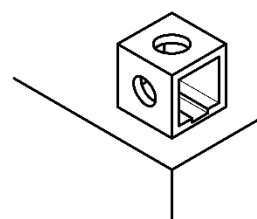

Alternatives

LP Batteries

Technology	Art. number
LFP	ML LFP5
GEL	MG LTX4-3
AGM	MA LTX4L-BS
DRY	-

Other Brands

IA CTX4L-BS - IG CTX4L-BS - CTZ5-S - IL LFP5

(Note) All above information shall be changed without prior notice, Landport Batteries reserves the right to explain and update the latest information.