



DYNAC SEMI TRACTION

STV 27DC

EAN CODE: 8717101014066

18/06/2025

### Description

Dynac Semi-Traction is a semi-traction battery which provides energy for onboard energy consumers of motorhomes, caravans and boats or trucks and buses. These onboard energy consumers, such as lighting, refrigerators and onboard computers or tail lifts, demand massive cyclic performance of a battery. Dynac Semi-Traction is resistant to deep discharges up to 50% and is suitable for seasonal use. Ideal for leisure vehicles with light to medium power consumers. Available in a range of 12V batteries from 50Ah to 230Ah in series wet charged and sealed maintenance free (SMF).

### Performance

Nominal Voltage	12
Capacity	90Ah (20hr, 1.75V/cell)
Capacity	72Ah (5hr, 1.7V/cell)
RC 25A	165
CCA EN	650

### Dimensions / Casing / Weight

Box Type	27
Dimensions	Length: 303 mm
	Width: 172 mm
	Height: 200 mm
	Total Height: 223 mm
Net Weight	23.16 Kg
Acid Volume	6.8
Material Casing / Lid	Polypropylene

### Technical Characteristics

Technology	Flooded Calcium
Separator	PE

### Charging instructions

Cycle use charge recommendation, Voltage	14.4
Cycle use charge recommendation, Max Amps	50 (absorbion charging recommended, constant current 14.4±0.1V not exceeding 50A)
Float charge recommendation, Voltage	13.35 (Float charging recommended, constant current 13.35V±0.1V)
Cycles at 50% DoD	350 (1st Cycle 4.5A discharge rate until 10.5V)
Bulk charging = constant current = 20Hr current for recharge	



### Features

- Reliable power supply
- Deep discharges up to 50%
- Ideal for seasonal use
- Available as wet charged or sealed maintenance free (SMF)
- Recommended for leisure vehicles with light to medium power consumers

### Layout

### Terminal

### Hold-down

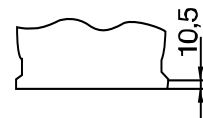
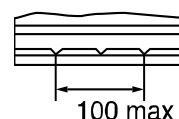
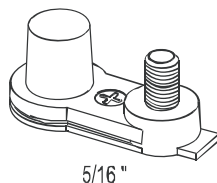

### Battery Classifications as per EN 50342-6

Water Consumption	Charge Retention	Vibration Resistance	Endurance Level
W4	C2	V2	E1

(Note) All above information shall be changed without prior notice, Landport Batteries reserves the right to explain and update the latest information.